

ROHS

客户图

目錄

MAPX

變更內容  
MODIFICATION

NEW

日期  
DATE

09-10-20

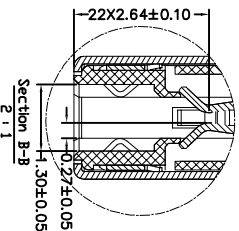
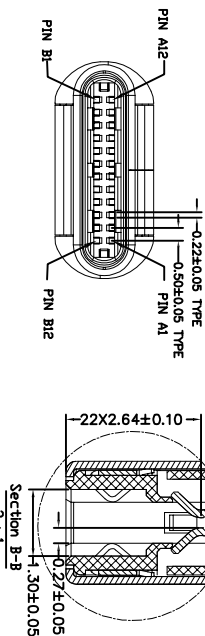
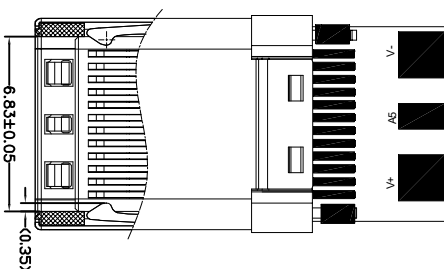
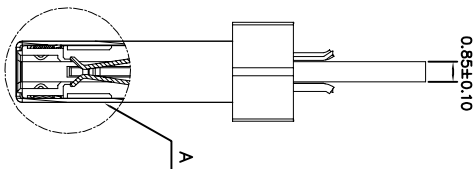
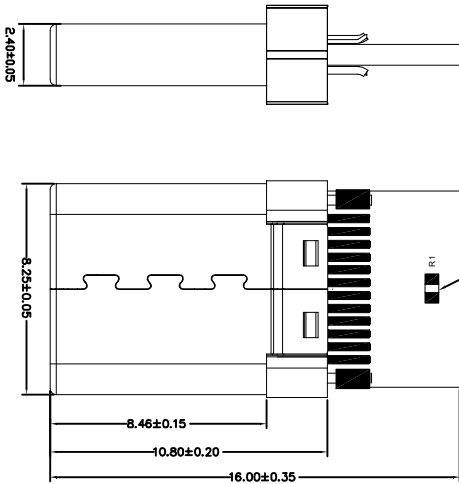
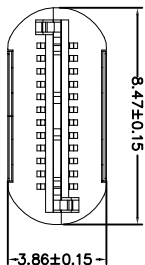

Pin No.	host	device	Pin No.	host	device
Pin A1	GND	GND	Pin B12	GND	GND
Pin A2	SSTx01	SSTx01	Pin B11	SSRw01	SSRw01
Pin A3	SSTx01	SSTx01	Pin B10	SSRw01	SSRw01
Pin A4	VBUS	VBUS	Pin B9	VBUS	VBUS
Pin A5	CC1	CC1	Pin B8	SBU2	SBU2
Pin A6	DPI	DPI	Pin B7		
Pin A7	DN1	DN1	Pin B6	CC2	CC2
Pin A8	SBU1	SBU1	Pin B5	VBUS	VBUS
Pin A9	VBUS	VBUS	Pin B4	VBUS	VBUS
Pin A10	SSRw02	SSRw02	Pin B3	SSTxw2	SSTxw2
Pin A11	SSRw02	SSRw02	Pin B2	SSTxw2	SSTxw2
Pin A12	GND	GND	Pin B1	GND	GND

- 备注:
1. 材料: See Table A
  2. 包装要求: See Table A
  3. 引线特性: 插入力: 5-20N 拔出力: 8-20N, 1000次插拔后 (6-20N) 耐久寿命: 10 000次
  4. 电气特性: 接触电阻: 40mOhms Max(Inital) Sometimes Max(after) 绝缘电阻: 1000Mhms Min 额定电流: 5A for VHSK for AA/AB/B4/B9) 1.25A for Veonm and ONY for AI/AI.2/BI/BS/BI.2) 0.25A for all other contacts.
  5. 环境特性: 温度范围: 存储: -55°C, 35°C, 40°C 操作: -55°C~80°C 工作温度: -25°C~80°C
  5. 使用物料及制程符合RoHS/RE.

6	LATCH	STAINLESS	: Ni: 50u"
5	CONTACT	COPPER ALLOY	Contact area: 5u", Solder tails: Tin80u", Ni: 30~80u"
4	molding 2	L.C.P	(Black)
3	GNDSPRING	STAINLESS	
2	Molding	L.C.P	(Black)
1	SHELL	STAINLESS	Ni: 50u"

产品图 PRODUCT CHART DWG

深圳市鑫风雷电子有限公司

公差一览表 TOLERANCE UNLESS OTHERWISE		单位 UNITS	MM	制图 DRAWING	王冠	产品料号 PRODUCT PART NO.	XFLY012-UCAM010-X
X	±0.30	X	±5'	审核 CHKD	雷永健	产品名称 PRODUCT NO.	TYPE C公头冲压款带2.0充电板三个焊位
.XX	±0.25	.XX	±2'	核准 APPD	雷永健	角法 VIEW	⊕ ⊖
.XXX	±0.15	.XXX	±0.5'	日期 DATE		版本 VER	A0
				2009/10/20			