

RoHS 客户图

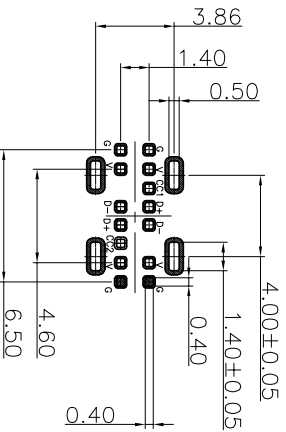

RECOMMENDED: P.C.B. LAYOUT
TOLERANCE UNSPECIFIED: ±0.05mm

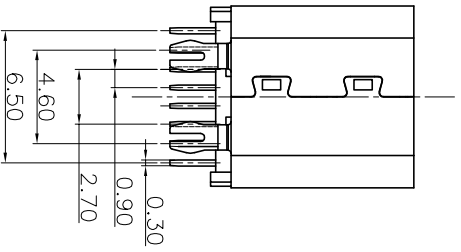
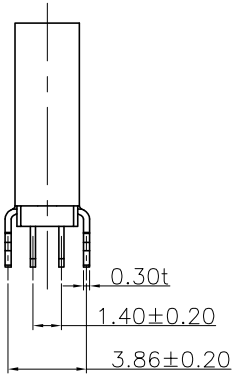
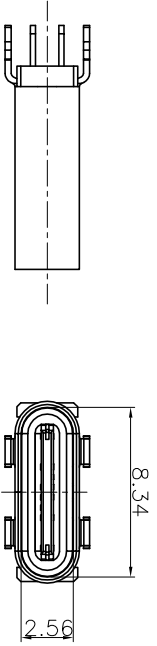
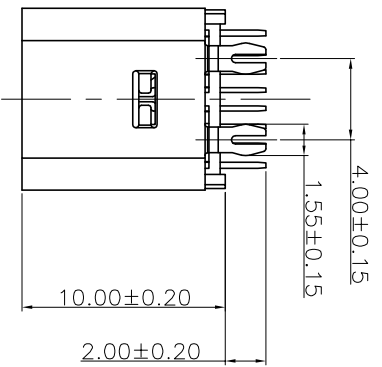
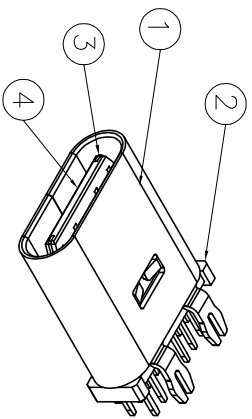

- SPECIFICATION:
- CURRENT RATING: 5.0A MAX
 - Withstanding Voltage: 100V AC
 - TEMPERATURE RANGE: -30 °C ~ 85 °C
 - CONTACT RESISTANCE: 40 MILLIONHM MAX
 - INSULATION RESISTANCE: 100 MEGOHMS
 - INSERTION FORCE : 5N~20N
 - UNMATING FORCE: 8N~20N (1~1000次)
 - DURABILITY: 10,000 CYCLES 6N~20N (10000次之用)

NO.	DESCRIPTION	MATERIAL	COLOR	REMARK
1	SHELL	STAINLESS STEEL	—	Ni Plated
2	TYPE C TERMINAL	COPPER ALLOY	—	Gold Plated
3	CENTER PIECE	STAINLESS STEEL	—	NO Plated
4	TYPE C MD	HIGH TEMP	BLACK	UL 94V-0
5				
6				
7				

深圳市鑫风雷电子有限公司

公差一览表	
TOLERANCE UNLESS OTHERWISE	公差一览表
X	±0.30
X	±0.25
XX	±0.30
XXX	±0.15

单位	MM	制图	王冠	产品料号	13002-UCAP003-X
UNITS	MM	DRAWING	CHD	PRODUCT NO.	
比例	1:1	审核	雷永健	产品名称	TYPE C 2.0*2.0*14PIN 180度插板
SCALE		核准	雷永健	角法	TYPE C 2.0*2.0*14PIN 180度插板
日期	2009/10/20	APPD		版本	A0
DATE				VER	

目錄	变更内容	日期
MAPX	MODIFICATION	DATE
A0	NEW	09-10-20