

ROHS 客户图

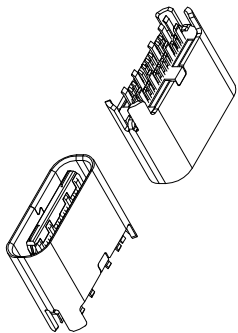

NOTES: 1.MATERIAL: LCP U194 V-0
CONTACT: COPPER ALLOY
GOLD PLATED Min ON CONTACT AREA:100μ"
Min TIN (LEAD FREE) ON SOLDER AREA,
SHELL: SUS304-H1=0.30±0.03mm
SHELL: S02 NICKEL PLATING OVER ALL.
SHL.DS:104-H1=0.12±0.03mm
2.MECHANICAL
INSERTION: 5~20N
EXTRACTION: 8~20N AFTER TEST.
DURABILITY: 10000 CYCLES
3.ELECTRICAL:
CURRENT: 5A FOR VBUS,
VOLTAGE: 20 V MAX.
WITHSTANDING VOLTAGE: 100V AC R.M.S.
CONTACT RESISTANCE: 40mΩ MAX.
INSULATION RESISTANCE: 100MΩ MIN.
4.ENVIRONMENTAL
TEMPERATURE RANGE: -25°C ~ +85°C

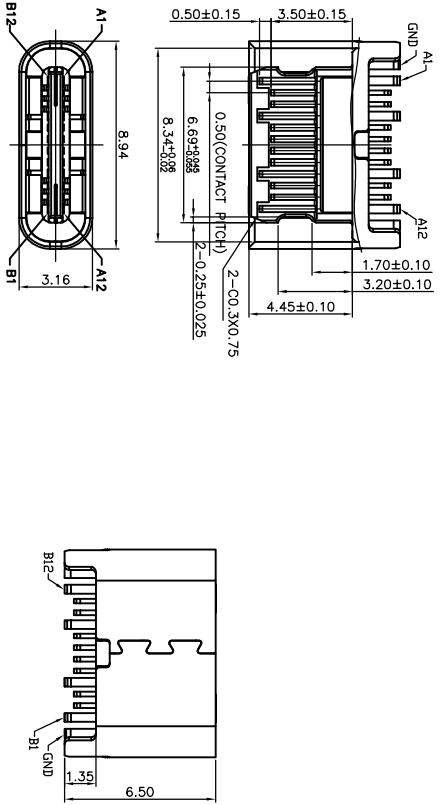
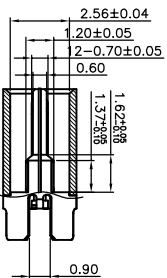

| Pin | Signal Name | Description | Pin | Signal Name | Description |
|-----|-------------|--|-----|-------------|--|
| A1 | GND | Ground return | B12 | GND | Ground return |
| A2 | SR10A | Positive half of first SuperSpeed TX differential pair | B11 | SR09A | Positive half of first SuperSpeed RX differential pair |
| A3 | SR10A | Negative half of first SuperSpeed TX differential pair | B10 | SR09A | Negative half of first SuperSpeed RX differential pair |
| A4 | Vbus | Bus Power | B9 | Vbus | Bus Power |
| A5 | CC1 | Common | B8 | SR12 | Standalone (SR) Common |
| A6 | Bp1 | Positive half of the USB 2.0 differential pair-Fossion 1 | B7 | Bp2 | Negative half of the USB 2.0 differential pair-Fossion 2 |
| A7 | Bn1 | Negative half of the USB 2.0 differential pair-Fossion 1 | B6 | Bp2 | Positive half of the USB 2.0 differential pair-Fossion 2 |
| A8 | SH11 | Standalone (SR) Common | B5 | CC2 | Common |
| A9 | Vbus | Bus Power | B4 | Vbus | Bus Power |
| A10 | SR10A2 | Positive half of second SuperSpeed TX differential pair | B3 | SR10A2 | Negative half of second SuperSpeed TX differential pair |
| A11 | SR10A2 | Negative half of second SuperSpeed TX differential pair | B2 | SR10A2 | Positive half of second SuperSpeed TX differential pair |
| A12 | GND | Ground return | B1 | GND | Ground return |

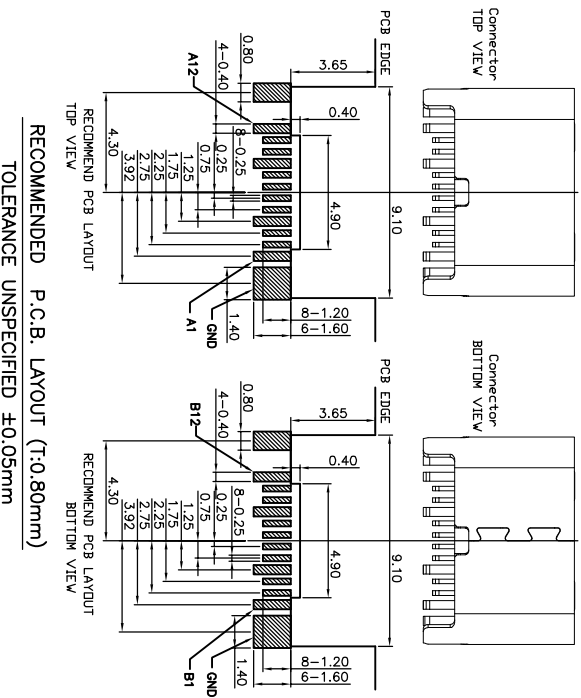

产品图
PRODUCT CHART DWG

公差一览表
TOLERANCE UNLESS OTHERWISE

| | | | |
|-----|-------|------|-------|
| X | ±0.30 | X' | ±5' |
| X | ±0.25 | X' | ±2' |
| XX | ±0.30 | XX' | ±1' |
| XXX | ±0.15 | XXX' | ±0.5' |

深圳市鑫风雷电子有限公司

| | | | | | |
|------|------------|------|-----|------|------------------|
| 单位 | MM | 制图 | 王冠 | 产品料号 | 12001-UCAP001-X |
| 比例 | 1:1 | 审核 | 雷永健 | 产品名称 | TYPE C母座夹板短体-6.5 |
| 日期 | 2009/10/20 | 核准 | 雷永健 | 图法 | 版本 |
| DATE | | APPD | | VIEW | A0 |

