

# RoHS 客户图

目錄 MAPX A0	變更內容 MODIFICATION NEW	日期 DATE 09-10-20
------------------	-----------------------------	------------------------

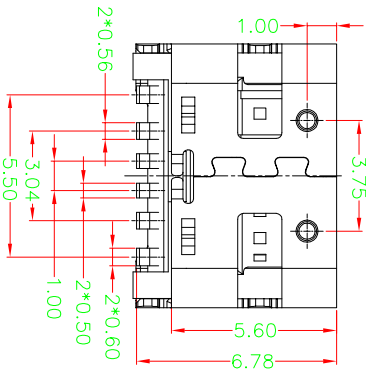
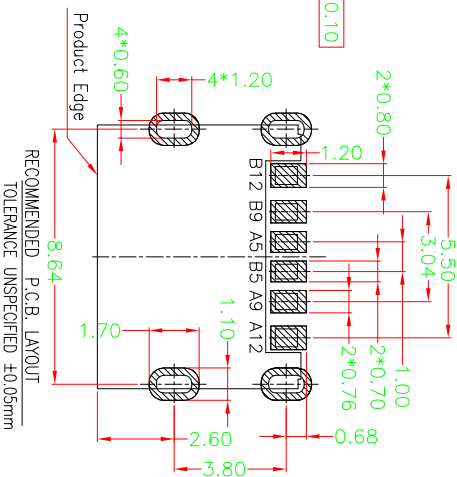
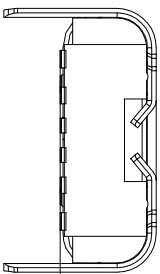
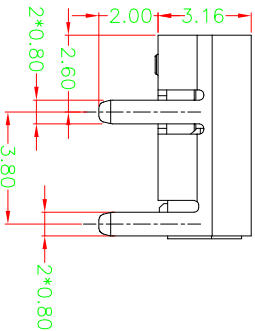
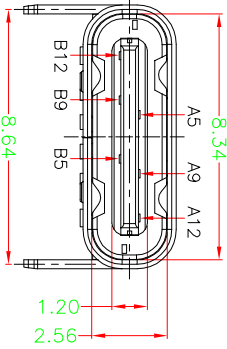
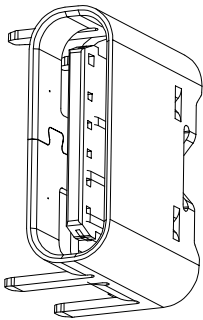
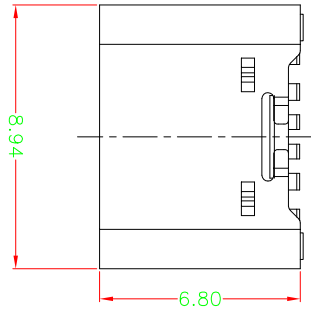

- NOTES:  
SPECIFICATION:
1. CURRENT RATING: 5.0A MAX
  2. VOLTAGE: 100 VAC
  3. TEMPERATURE RANGE: -30 °C ~ 85 °C
  4. CONTACT RESISTANCE: 40 MILLIONHM MAX
  5. INSULATION RESISTANCE: 100 MEGOHMS MIN.
  6. INSERTION FORCE : 5N~20N
  7. UNMATING FORCE: 8N~20N
  8. DURABILITY: 10000 CYCLES

3	SHELL	STAINLESS STEEL	Ni:80U <sup>+</sup> Plated	1SET
2	CONTACT	COPPER ALLOY	Au1u <sup>+</sup> /Ni:50U <sup>+</sup> Plated	1SET
1	HOUSING	HIGH TEMPERATURE PLASTIC	BLACK	1PCS
NO.	DESCRIPTION	MATERIAL	REMARKS	QTY

## 产品图

PRODUCT CHART DWG

### 公差一览表

公称	公差	说明
A5	CCI	B12 GND
A9	VBUS	B9 VBUS
A12	GND	B5 CC2
PIN	SIGNAL NAME	PIN SIGNAL NAME

公差	公差	公差	公差
X	±0.30	X <sup>+</sup>	±5 <sup>+</sup>
X	±0.25	X <sup>-</sup>	±2 <sup>-</sup>
XX	±0.30	XX <sup>+</sup>	±1 <sup>+</sup>
XXX	±0.15	XXX <sup>+</sup>	±0.5 <sup>+</sup>

单位	比例	制图	审核	日期	核准	产品料号	产品名称	图法	版本
MM	1:1	王冠	雷永健	2009/10/20	雷永健	12011-UCAP014-X	TYPE C 6P母座板上单排SMT	1:6, 8 种制片脚长2.0	A0