

RoHS 客户图

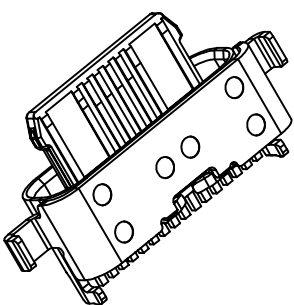
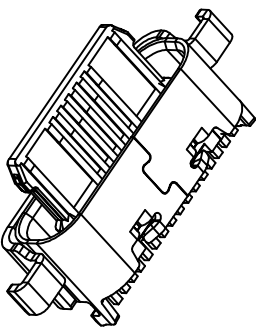
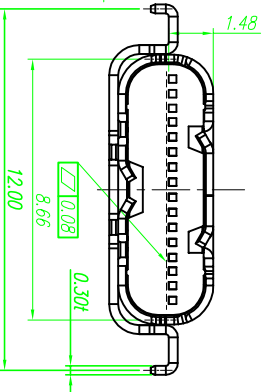
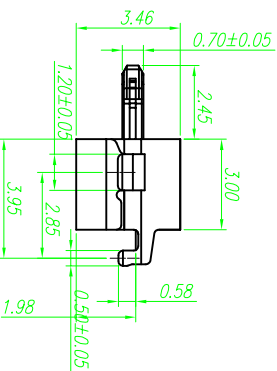
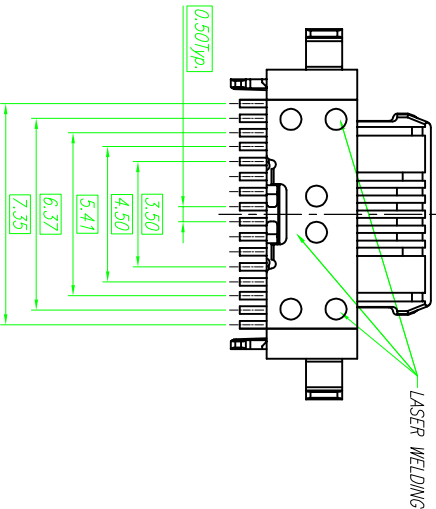
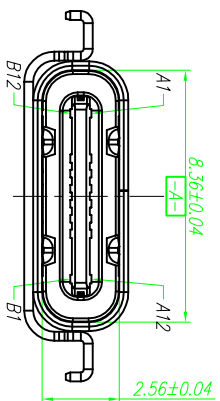
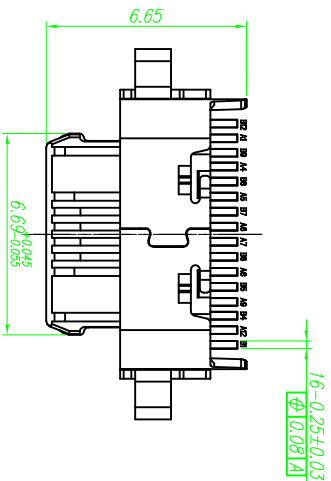

SPECIFICATION:

1. ELECTRICAL CHARACTERISTICS:

- 1.1 CURRENT RATING: 5 A
- 1.2 TEMPERATURE RANGE: -40 °C ~ 85 °C
- 1.3 CONTACT RESISTANCE: 30 MILLIONHM MAX.
- 1.4 DIELECTRIC WITHSTANDING VOLTAGE: 100 VAC r.m.s
- 1.5 INSULATION RESISTANCE: 100 MEGOHMS MIN.

2. MECHANICAL CHARACTERISTICS

- 2.1 INSERTION FORCE: 5~20N
- 2.2 EXTRACTION FORCE: Initial:8~20N, AFTER TEST 6~20N
- 2.3 DURABILITY: 10,000CYCLES

3. THE SHELL LENGTH IS LESS THAN THE MINIMUM SPECIFIED BY THE USB TYPE C STANDARD. AS SUCH IS CANNOT INDEPENDENTLY BE GUARANTEED TO MEET ALL TYPE C MECHANICAL REQUIREMENTS.

产品图

PRODUCT CHART DWG

公差一览表

TOLERANCE UNLESS OTHERWISE	公差	UNIT	比例	日期	制图	审核	核准	产品料号	产品名称	角法	版本
UNITS	SCALE	DATE	DRAWING CHD	APPD	DATE	DATE	DATE	PRODUCT NO.	TYPE C 18P母座规格1.98 外插舌片2.45 L=6.65	VIEW	VER
X	±0.30	X'	±5'		王冠	雷永健	雷永健	19009-UCAF011-X			A0
XX	±0.25	X''	±2'								
XXX	±0.15	XXX'	±0.5'	2009/10/20							

深圳市鑫风雷电子有限公司
Shenzhen xinfenglei Electronic Co., Ltd

目錄	修改內容	日期
MAPX	MODIFICATION	DATE
A0	NEW	09-10-20

RoHS

客户图

目錄 MAPX A0	變更內容 MODIFICATION NEW	日期 DATE 09-10-20
------------------	-----------------------------	------------------------

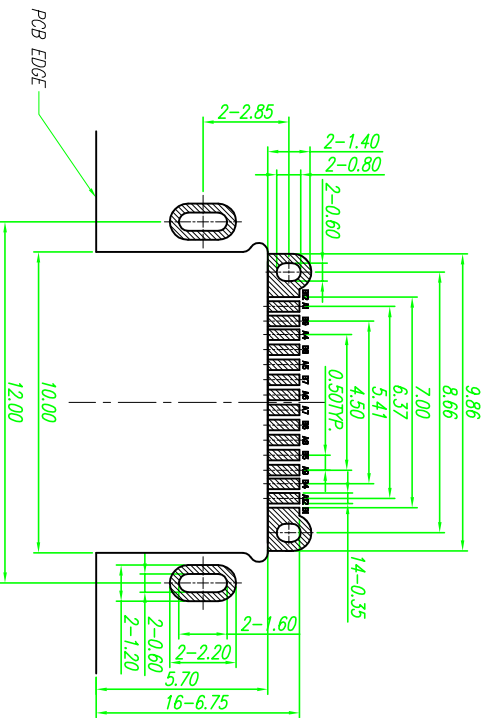
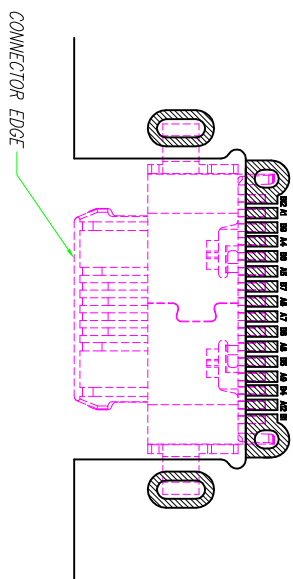

P.C.B. LAYOUT VIEW

TOLERANCE ±0.05

PIN ASSIGNMENT

Pin	Signal Name	Pin	Signal Name	Pin	Signal Name	Pin	Signal Name
A1	GND	B12	GND	A7	D-	B6	D+
A2	TX1+	B11	RX1-	A8	SBU1	B5	CC2
A3	TX1-	B10	RX1+	A9	VBUS	B4	VBUS
A4	VBUS	B9	VBUS	A10	RX2-	B3	TX2+
A5	CC1	B8	SBU2	A11	RX2+	B2	TX2+
A6	D+	B7	D-	A12	GND	B1	GND

产品图

PRODUCT CHART DWG

公差一览表

TOLERANCE UNLESS OTHERWISE	X	XX	XXX
±0.30	X	XX	XXX
±0.25	X	XX	XXX
±0.30	X	XX	XXX
±0.15	X	XX	XXX

深圳市鑫风雷电子有限公司
Shenzhen xinfenglei Electronic Co., Ltd

NO.	DESCRIPTION	QTY.	MATERIAL	FINISHED
4	MID PLATE	1 PCS	STAINLESS STEEL	Ni Plated
3	CONTACT	1 SET	COPPER ALLOY	Au & Ni Plated
2	MOLDING HOUSING	1 PCS	PLASTIC	None
1	SHELL	1 PCS	STAINLESS STEEL	Ni Plated

单位 UNITS	比例 SCALE	日期 DATE	制图 DRAWING	审核 CHECK	核准 APPR	产品料号 PRODUCT PART NO.	产品名称 PRODUCT NO.	角法 VIEW	版本 VER
MM	1:1	2009/10/20	王冠	雷永健	雷永健	19009-UCAF011-X	TYPE C 16P 母座 流规:1.98 外露舌片:2.45 1-6: .65	⊕	A0

ROHS 客户图

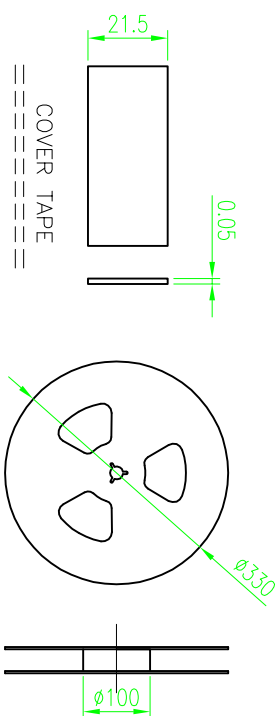
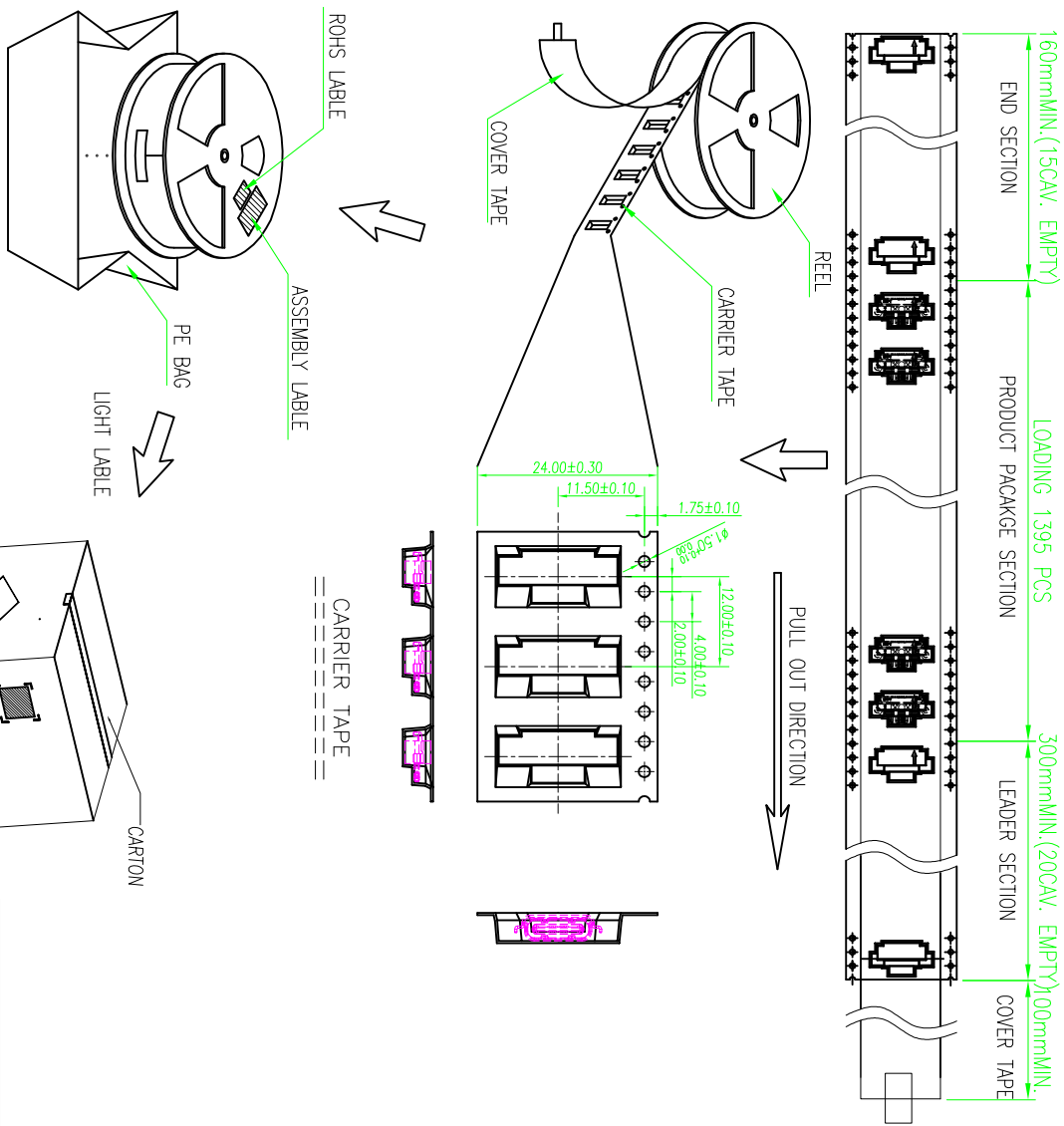

NOTES 2:

1. MATERIAL:
 - 1.1 REEL AND AXLE: PS,BLUE
 - 1.2 CARRIER TAPE: PET, LUCID
 - 1.3 COVER TAPE: PS, TRANSPARENT
 - 1.4 SHIPPING CARTON: CORRUGATED FIBER
2. DIMENSION:
 - 2.1 REEL: W=24.5, ØA=330
 - 2.2 CARRIER TAPE: T=0.50 W=24.0
 - 2.3 COVER TAPE: T=0.05 W=21.3
 - 2.4 SHIPPING CARTON: L=335mm, W=335mm, H=425mm
3. QUANTITY :
 - 3.1 PRIMARY PACKING: 1395PCS/REEL
 - 3.2 SECONDARY PACKING: 12 REELS/CARTON(16740PCS/CARTON)
4. PEELING RESISTANCE: 0.1~1.3N
 - 4.1 PEELING SPEED: 300mm/minutes
 - 4.2 PEELING ANGLE: 165°~180°

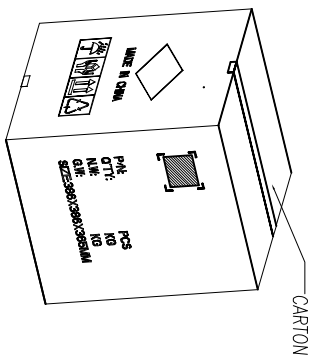

公差一览表		单位		比例		日期	
TOLERANCE UNLESS OTHERWISE		UNITS		SCALE		DATE	
X	±0.30	X'	±5'	1:1	2009/10/20	王冠	雷永健
X	±0.25	X'	±2'	1:1	2009/10/20	王冠	雷永健
XX	±0.30	XX'	±1'	1:1	2009/10/20	王冠	雷永健
XXX	±0.15	XXX'	±0.5'	1:1	2009/10/20	王冠	雷永健

产品图
Product Chart DWG
Shenzhen xinfenglei Electronic Co., Ltd

制图	审核	核准	产品料号	产品名称	角法	版本
DRAWING	CHECK	APPROV	PRODUCT PART NO.	PRODUCT NAME	TYPE	VER
王冠	雷永健	雷永健	19009-UCAP011-X	TYPE C 16P封装板 1.98 外露舌片 2.45 L=6.65	30°	A0