

# ROHS 客户图

目錄 MAPX	變更內容 MODIFICATION	日期 DATE
A0	NEW	09-10-20

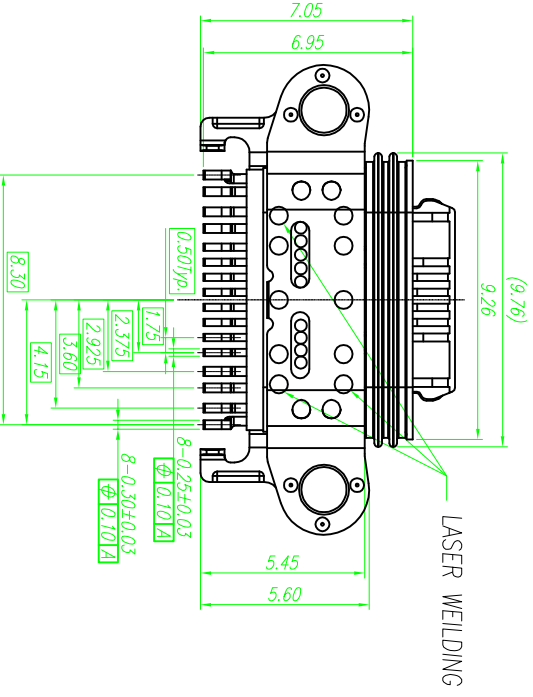
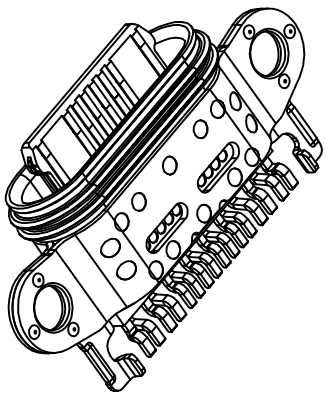
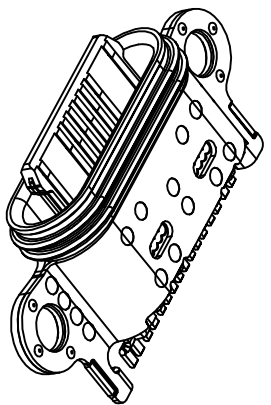
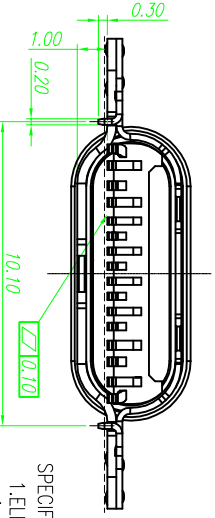
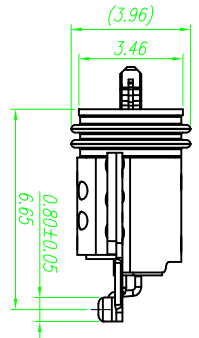
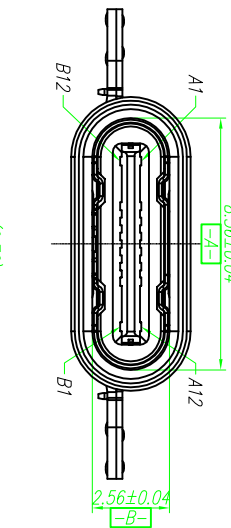
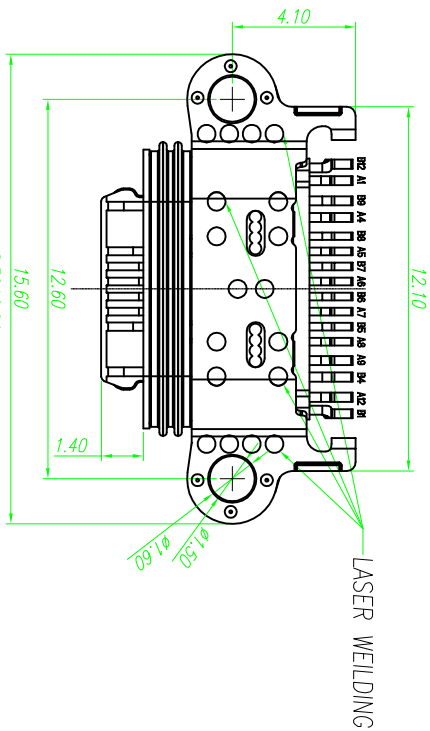

LASER WELDING

LASER WELDING

**SPECIFICATION:**

- 1. ELECTRICAL CHARACTERISTICS:**
- 1.1 CURRENT RATING: 6A
  - 1.2 TEMPERATURE RANGE: -40 °C ~ 85 °C
  - 1.3 CONTACT RESISTANCE: 30 MILLIONHM MAX.
  - 1.4 DIELECTRIC WITHSTANDING VOLTAGE: 100 VAC r.m.s
  - 1.5 INSULATION RESISTANCE: 100 MEGOHMS MIN.
- 2. MECHANICAL CHARACTERISTICS**
- 2.1 INSERTION FORCE: 5~20N
  - 2.2 EXTRACTION FORCE: Initial:8~20N, ATER TEST 6~20N
  - 2.3 DURABILITY:10,000CYCLES
- 3. THE SHELL LENGTH IS LESS THAN THE MINIMUM SPECIFIED BY THE USB TYPE C STANDARD.SUCH IS CANNOT INDEPENDENTLY BE GUARANTEED TO MEET ALL TYPE C MECHANICAL REQUIREMENTS.**

**产品图**

PRODUCT CHART DWG

**公差一览表**

TOLERANCE UNLESS OTHERWISE	公差一览表	单位 UNITS	比例 SCALE	日期 DATE	制图 DRAWING	审核 CHKD	核准 APPRD	产品料号 PRODUCT PART NO.	产品名称 PRODUCT NO.	角法 VIEW	版本 VER
X	±0.30	X	±5°		王冠	雷永健	雷永健	19009-UCAP008-X	TYPE C 16P母座面板I/O 外露舌片		
XX	±0.25	X'	±2°		王冠	雷永健	雷永健		1.4 防水型带螺丝孔 2.46H 1.8-45		
XXX	±0.15	XXX'	±0.5°	2009/10/20	王冠	雷永健	雷永健				A0

深圳市鑫风雷电子有限公司  
Shenzhen xinfenglei Electronic Co., Ltd

# ROHS

# 客户图

目錄 MAPX A0	變更內容 MODIFICATION NEW	日期 DATE 09-10-20
------------------	-----------------------------	------------------------

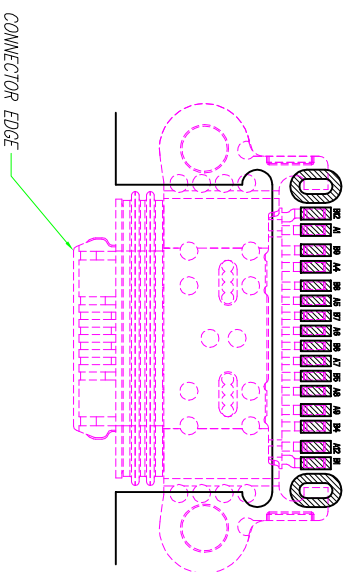

### PIN ASSIGNMENT

Pin	Signal Name	Pin	Signal Name	Pin	Signal Name	Pin	Signal Name
A1	GND	B12	GND	A7	D-	B6	D+
A2	TX1+	B11	RX1-	A8	SBU1	B5	CC2
A3	TX1-	B10	RX1+	A9	VBUS	B4	VBUS
A4	VBUS	B9	VBUS	A10	RX2-	B3	TY2+
A5	CC1	B8	SBU2	A11	RX2+	B2	TY2+
A6	D+	B7	D-	A12	GND	B1	GND

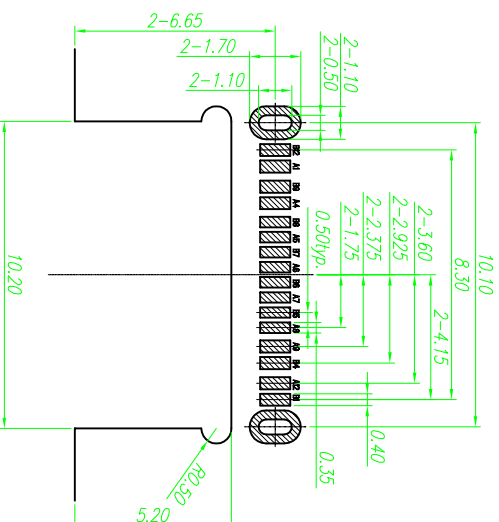

### P.C.B LAYOUT VIEW

TOLERANCE ±0.05

NO.	DESCRIPTION	QTY.	MATERIAL	FINISHED
4	MID_PLATE	1 PCS	STAINLESS STEEL	Ni Plated
3	CONTACT	1 SET	COPPER ALLOY	Au & Ni Plated
2	MOLDING HOUSING	1 PCS	PLASTIC	None
1	SHELL	1 PCS	STAINLESS STEEL	Ni Plated

### 产品图

PRODUCT CHART DWG

### 公差一览表

TOLERANCE UNLESS OTHERWISE	公差	UNIT	比例	日期	制图	审核	核准备	产品料号	产品名称	角法	版本
X	±0.30	X'	±5'	SCALE	王冠	雷永健	雷永健	19009-UCAF008-X	TYPE C 16P母座沉板L 0 外露舌片	⊕	A0
.XX	±0.25	X'	±2'	DATE	CHD	CHD	CHD		L 4 防水型带螺丝孔 2.46H L-8.45	⊖	
.XXX	±0.30	XX'	±1'	2009/10/20	APPD	APPD	APPD			⊕	
.XXX	±0.15	XXX'	±0.5'							⊖	

深圳市鑫风雷电子有限公司  
Shenzhen xinfenglei Electronic Co., Ltd

# ROHS 客户图

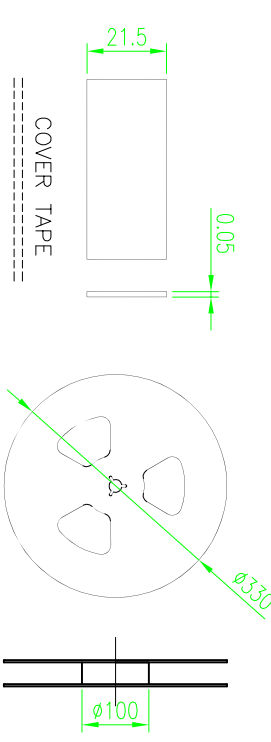
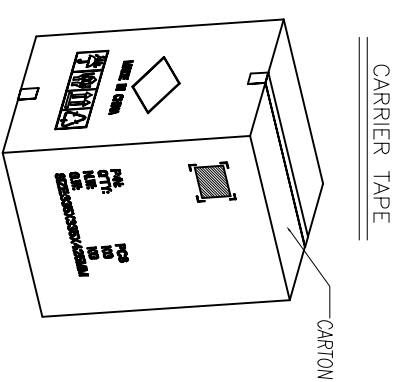
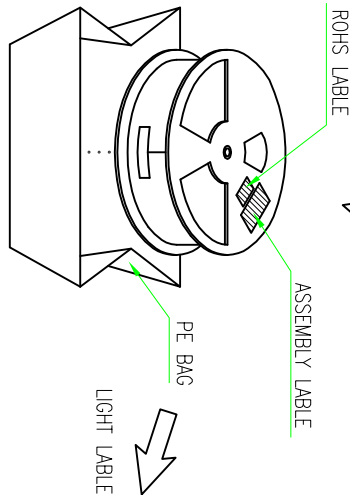
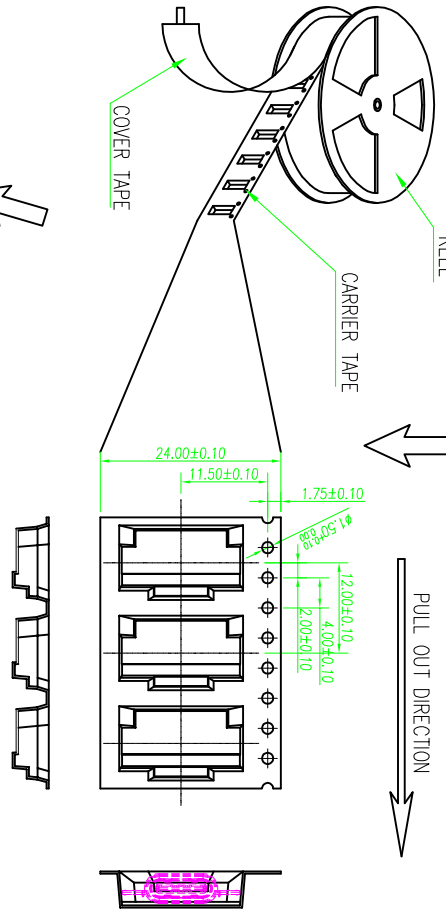
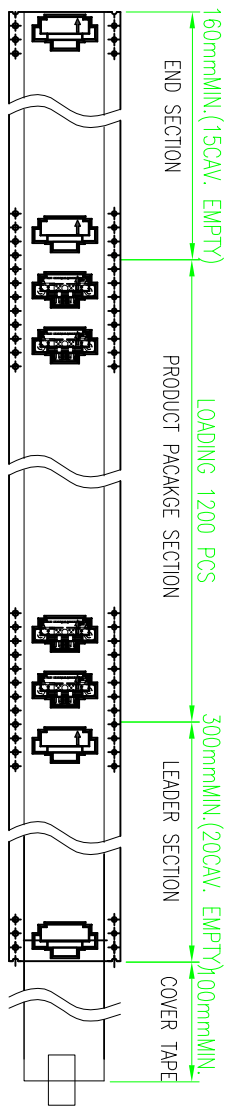

- NOTES: 2:
- MATERIAL:
    - 1.1 REEL AND AXLE: PS,BLUE
    - 1.2 CARRIER TAPE: PET, LUCID
    - 1.3 COVER TAPE: PS,TRANSPARENT
    - 1.4 SHIPPING CARTON: CORRUGATED FIBER
  - DIMENSION:
    - 2.1 REEL: W=24.5,  $\phi A=330$
    - 2.2 CARRIER TAPE: T=0.30 W=24.0
    - 2.3 COVER TAPE: T=0.05 W=21.5
    - 2.4 SHIPPING CARTON: L=335mm, W=335mm, H=365mm
  - QUANTITY:
    - 3.1 PRIMARY PACKING: 1200PCS/REEL
    - 3.2 SECONDARY PACKING: 12 REELS/CARTON(14400PCS/CARTON)
  - PEELING RESISTANCE: 0.1~1.3N
    - 4.1 PEELING SPEED: 300mm/minutes
    - 4.2 PEELING ANGLE: 165° ~180°

公差一览表		单位		比例		日期	
TOLERANCE UNLESS OTHERWISE	UNIT	SCALE	DATE	DATE	DATE	DATE	DATE
X	±0.30	X'	±5'	1:1	2009/10/20		
X	±0.25	X'	±2'				
XX	±0.30	XX'	±1'				
XXX	±0.15	XXX'	±0.5'				

深圳市鑫风雷电子有限公司  
Shenzhen xinfenglei Electronic Co., Ltd

产品料号	产品名称	角法	版本
PRODUCT PART NO.	PRODUCT NAME	ANGLE	VERSION
19009-UCAR008-X	TYPE C 16P母座沉板1.0 外露舌片	1.4 防水型带螺丝孔	2.46H L=8.45

目録	变更内容	日期
MAPX	MODIFICATION	DATE
A0	NEW	09-10-20