

ROHS 客户图

目錄 MAPX	變更內容 MODIFICATION	日期 DATE
A0	NEW	09-10-20

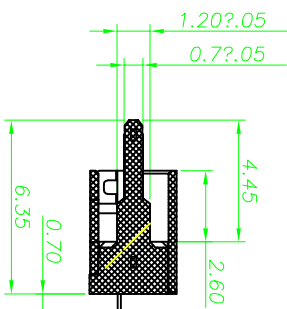
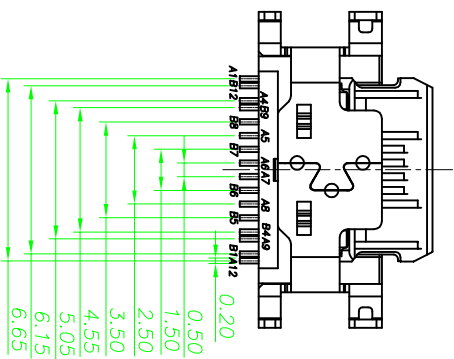
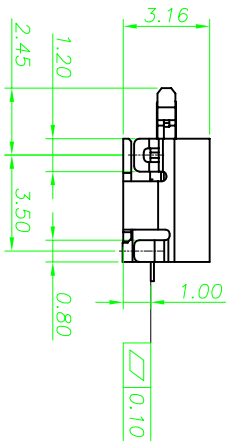
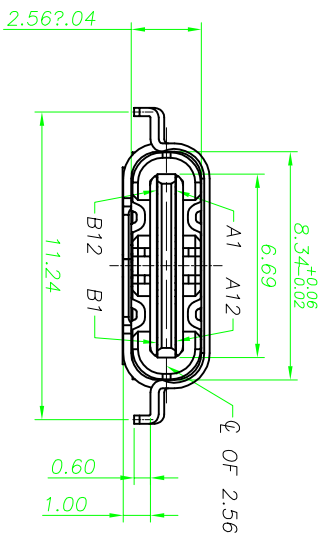
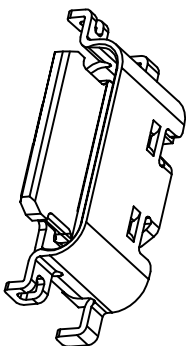
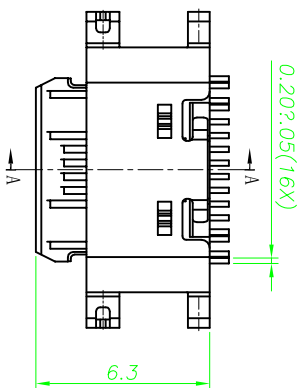

NOTE:

- 1.MATERIAL SPECIFICATION:
 - 1.HOUSING:HIGH TEMPERATURE RESISTANT PLASTIC,U194 V-0.
 - 2.CONTACTS:COPPER ALLOY
 - 3.MID PLATE: STAINLESS STEEL
 - 4.FRONT SHELL: STAINLESS STEEL
 - 2-PLATING SPECIFICATION:
 - 2-1.CONTACTS:
 - NI 50U" MIN. UNDER PLATED OVER ALL.
 - AU PLATED ON THE FUNCTIONAL AREA OF CONTACT.
 - (GOLD PLATING THICKNESS FOLLOW THE P/N)
 - PLATING SPECIFICATIONS OF THE SOLDER AREA FOLLOW THE P/N
 - 2-2.FRONT SHELL:
 - NI 30U" MIN. UNDER PLATED OVER ALL.
 - 2-3.MID PLATE:
 - CLEAR ONLY
 - 3.MECHANICAL PERFORMANCE.
 - 3-1.INSERTION FORCE: 0.5~2.0kgf.
 - 3-2.REMOVAL FORCE: 0.8kgf~2.0kgf.
 - 3-3.DURABILITY: 10000 CYCLES.
 - 4.ELECTRICAL PERFORMANCE.
 - 4-1. CURRENT RATING:5.0A
 - VOLTAGE RATING:5.0V
 - 4-2. LCCR:
 - VBUS & GND PINS AND OTHER PINS: 40mΩ/PIN MAX.
 - SHIELD: 50mΩ/MAX.
 - LCCR MAX. CHANGE OF ALL PINS: 10mΩ.
 - 4-3.INSULATION RESISTANCE: 100MΩ MIN
 - 4-4.DIELECTRIC WITHSTAND VOLTAGE:AC 100V FOR 1 MINUTE.
5. ENVIRONMENTAL PERFORMANCE:
- OPERATING TEMPERATURE: -25℃~+85℃.
- 6.IR REFLOW:
- THE PEAK TEMPERATURE ON THE BOARD SHALL BE MAINTAINED FOR 10 SECONDS AT 260°C.

产品图

PRODUCT CHART DWG

公差一览表

TOLERANCE UNLESS OTHERWISE	公差
X	±0.30
XX	±0.25
XXX	±0.15

深圳市鑫风雷电子有限公司

单位 UNITS	MM	制图 DRAWING	王冠	产品料号 PRODUCT PART NO.	24001-UCAF021-X
比例 SCALE	1:1	审核 CHKD	雷永健	产品名称 PRODUCT NO.	TYPE C母座16P沉板
日期 DATE	2009/10/20	核准 APPD	雷永健	角法 VIEW	1.0 (CH=0.58) 1=6.35
				版本 VER	A0

RoHS 客户图

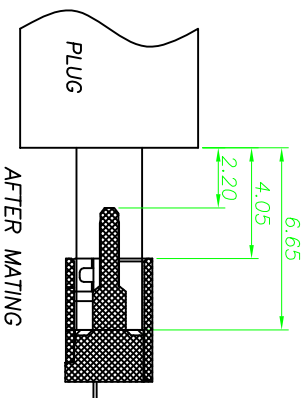

USB TYPE-C PIN ASSIGNMENTS

PIN NUMBER	SIGNAL NAME	PIN NUMBER	SIGNAL NAME
A1	GND	B12	GND
A4	VBUS	B9	VBUS
A5	CC1	B8	SBU2
A6	Dp1	B7	Dn2
A7	Dn1	B6	Dp2
A8	SBU1	B5	CC2
A9	VBUS	B4	VBUS
A12	GND	B1	GND

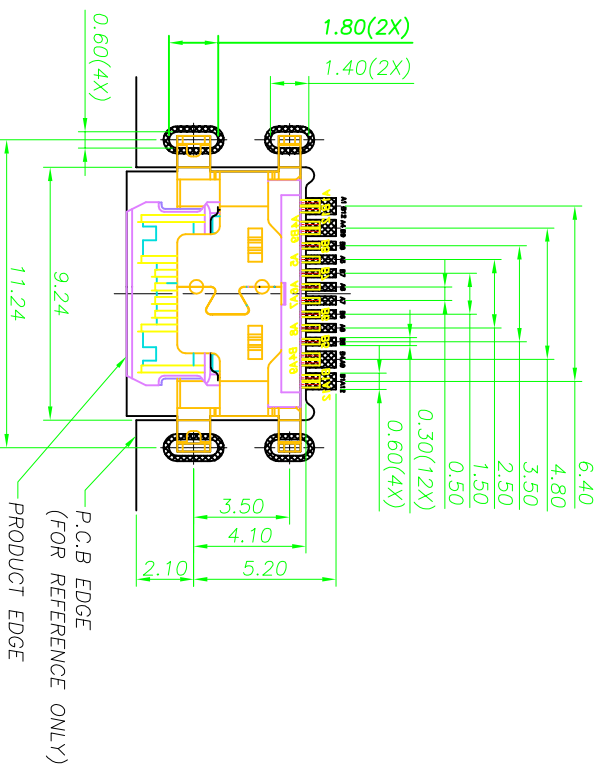

RECOMMENDED PCB LAYOUT(TOP VIEW)
THICKNESS 0.80MM;DEFAULT TOLERANCE:±0.05

深圳市鑫风雷电子有限公司

产品图		单位		制图		产品料号	
PRODUCT CHART DWG		UNITS		DRAWING		PRODUCT PART NO.	
公差一览表		MM	王冠	24001-UCAR021-X		TYPE C母座16P沉板	
TOLERANCE UNLESS OTHERWISE		1:1	雷永健	24001-UCAR021-X		TYPE C母座16P沉板	
X	±0.30	X'	±5'	比例	1:1	产品名称	1.0 (CH-0.58) 1=6.35
X	±0.25	X'	±2'	日期	2009/10/20	核准	雷永健
XX	±0.30	XX'	±1'	日期	2009/10/20	核准	雷永健
.XXX	±0.15	.XXX'	±0.5'	日期	2009/10/20	核准	雷永健

RoHS 客户图

目錄 MAPX A0	變更內容 MODIFICATION NEW	日期 DATE 09-10-20
------------------	-----------------------------	------------------------

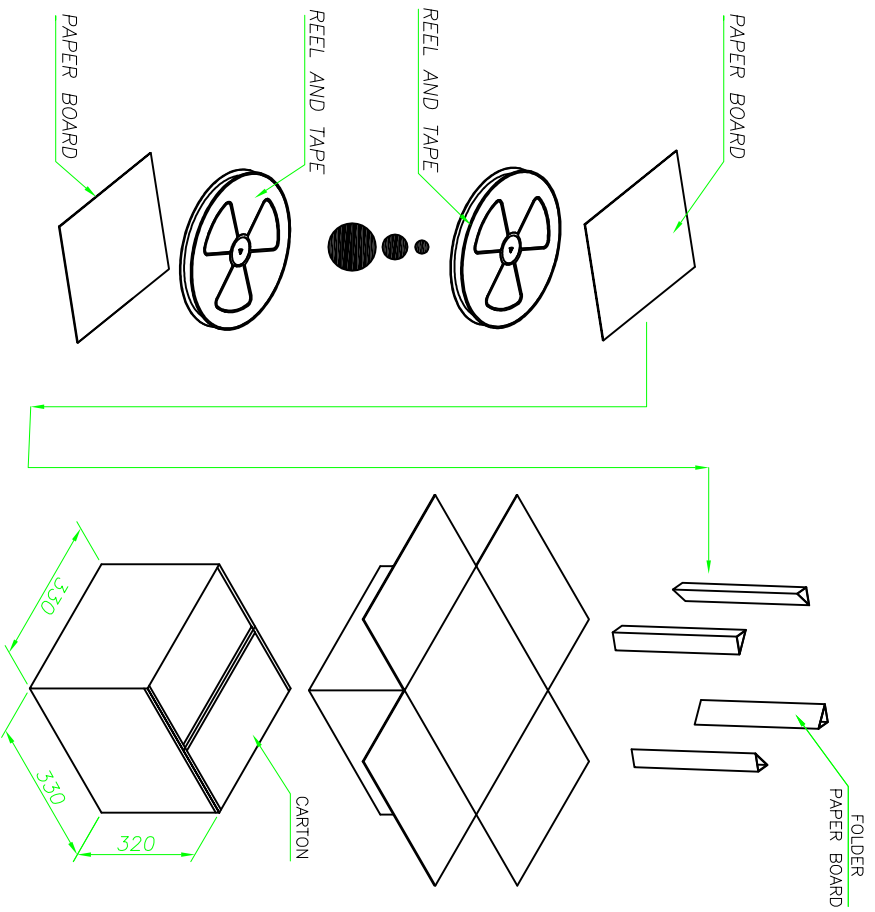
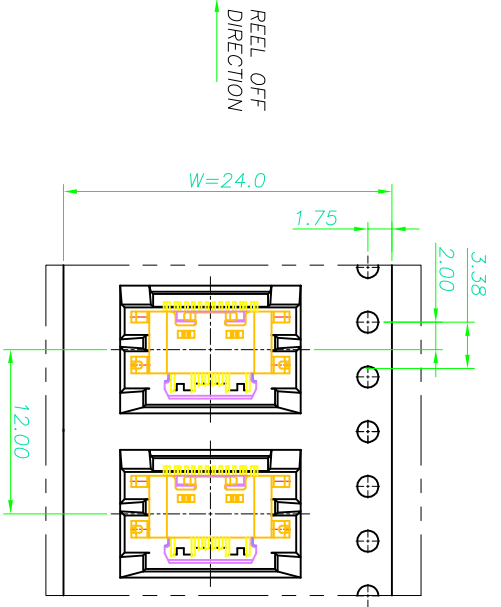
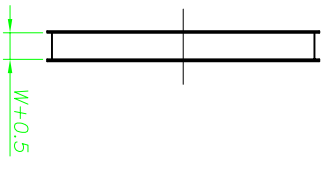
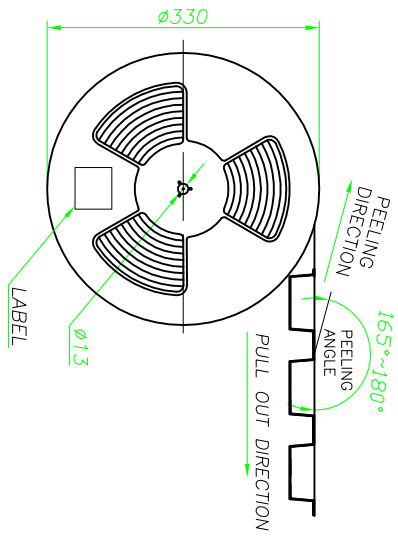
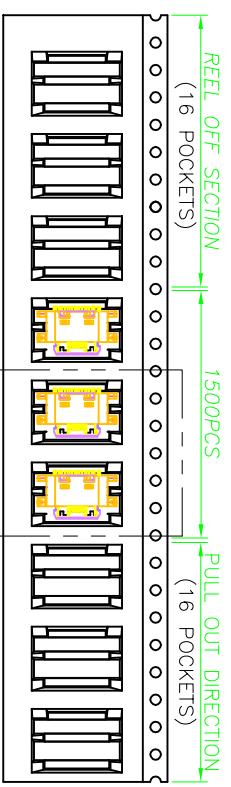

CONNECTOR (PCS)	REEL	CARTON
	1500	15000

产品图
PRODUCT CHART DWG

深圳市鑫风雷电子有限公司

公差一览表 TOLERANCE UNLESS OTHERWISE		单位 UNITS	MM	制图 DRAWING	王冠	产品料号 PRODUCT PART NO.	24001-UCAF021-X
X	±0.30	X	±5°	审核 CHKD	雷永健	产品名称 PRODUCT NO.	TYPE C母座16P沉板
.XX	±0.25	.X	±2°	核准 APPD	雷永健	角法 VIEW	1.0 (CH=0.58) I=6.35
.XXX	±0.30	.XX	±1°			版本 VER	A0
	±0.15	.XXX	±0.5°	日期 DATE			