

RoHS

客户图

目録 MAPX A0	变更内容 MODIFICATION NEW	日期 DATE 09-10-20
------------------	-----------------------------	------------------------

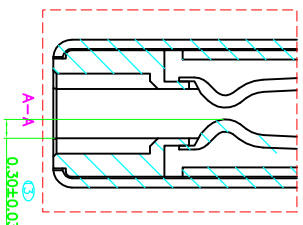
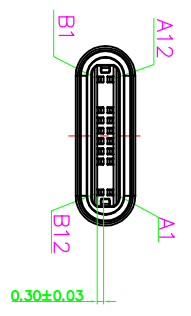
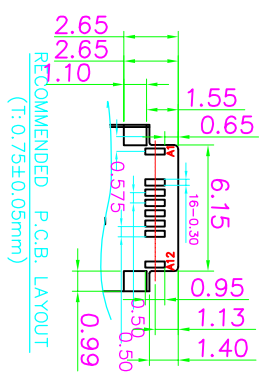
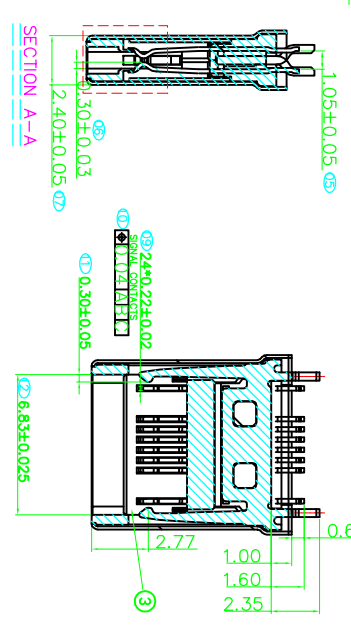
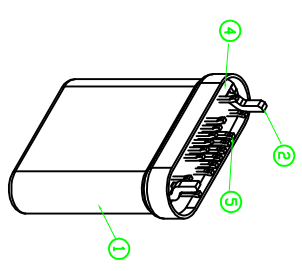
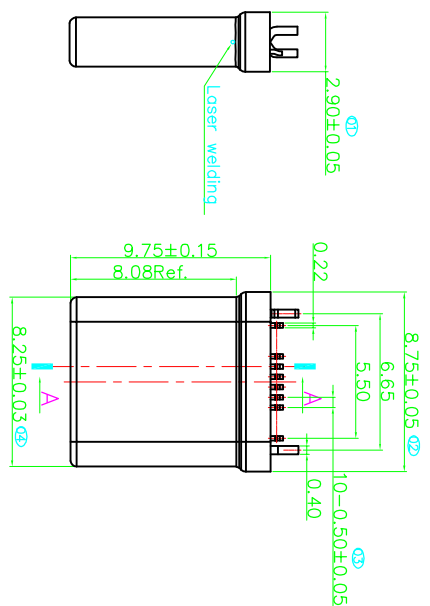
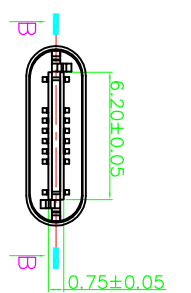

NO.	DESCRIPTION	MATERIAL	COLOR	REMARK
1	Shell	STAINLESS STEEL	—	Ni Plated
2	Terminal	COPPER ALLOY	—	Gold Plated
3	Latch	STAINLESS STEEL	—	SN Plated
4	Moding	HIGH TEMP	BLACK	UL 94V-0
5	Housing	HIGH TEMP	WHITE	UL 94V-0
6				
7				

公差一览表	
TOLERANCE UNLESS OTHERWISE	UNIT
X ±0.30	X' ±5'
X ±0.25	X' ±2'
XX ±0.30	XX' ±1'
XXX ±0.15	XXX' ±0.5'

产品图 PRODUCT CHART DWG	单位 UNITS	MM
比例 SCALE	1:1	
日期 DATE	2009/10/20	
制图 DRAWING	王冠	产品料号 PRODUCT PART NO.
审核 CHKD	雷永健	24007-UCAM001-B
核准 APPD	雷永健	产品名称 TYPE
角法 VIEW		C公头16P不带板(华为款)无孔
版本 VER	A0	

深圳市鑫风雷电子有限公司