

# RoHS 客户图

目錄 MAPX	變更內容 MODIFICATION	日期 DATE
A0	NEW	09-10-20

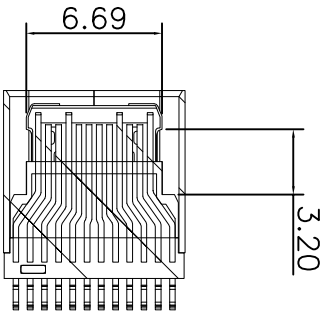

- NOTES:  
SPECIFICATION:
- CURRENT RATING: 5.0A MAX
  - VOLTAGE: 100 VAC
  - TEMPERATURE RANGE: -30 °C ~ 85 °C
  - CONTACT RESISTANCE: 40 MILLIONHM MAX
  - INSULATION RESISTANCE: 100 MEGOHMS MIN.
  - INSERTION FORCE : 5N~20N
  - UNMATING FORCE: 8N~20N
  - DURABILITY: 10,000 CYCLES

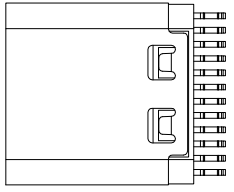
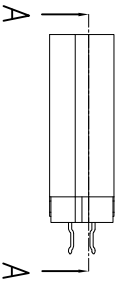
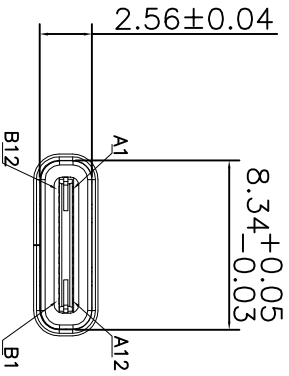

PIN	Signal Name	PIN	Signal Name
A1	GND	B12	GND
A2	/	B11	/
A3	/	B10	/
A4	VBUS	B9	VBUS
A5	CC1	B8	SUP2
A6	Dp1	B7	Dm2
A7	Dm1	B6	Dp2
A8	SUB1	B5	CC2
A9	VBUS	B4	VBUS
A10	/	B3	/
A11	/	B2	/
A12	GND	B1	GND

NO.	DESCRIPTION	MATERIAL	REMARKS	QTY
4	MID-PLATE	STAINLESS STEEL	---	1PCS
3	SHELL	STAINLESS STEEL	---	1PCS
2	CONTACT	COPPER ALLOY	Au1u"/Ni Plated	1SET
1	HOUSING	HIGH TEMPERATURE PLASTIC	BLACK	1PCS

## 产品图

PRODUCT CHART DWG

### 公差一览表

TOLERANCE UNLESS OTHERWISE SPECIFIED	公差
X	±0.30
.X	±0.25
.XX	±0.30
.XXX	±0.15

UNIT	MM	比例	日期	制图	审核	核准	产品料号	产品名称	角法	版本
UNITS	MM	1:1	2009/10/20	王冠	雷永健	雷永健	19003-UCAP003-X	TYPE C 24P夹板母座I=9.3	角法	A0

