

# RoHS 客户图

目錄 MAPX	變更內容 MODIFICATION	日期 DATE
A0	NEW	09-10-20

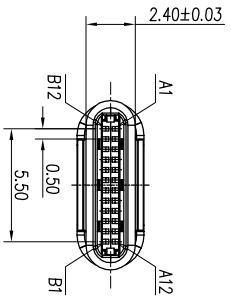
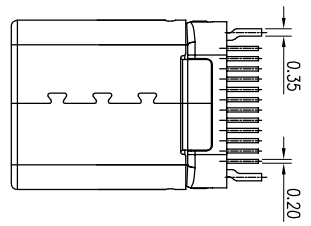
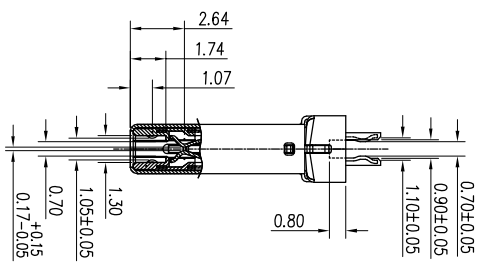
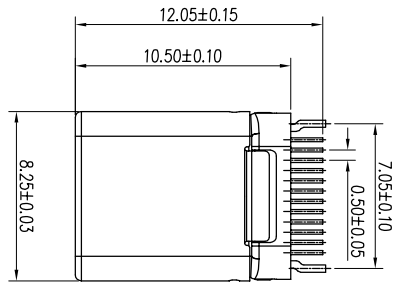
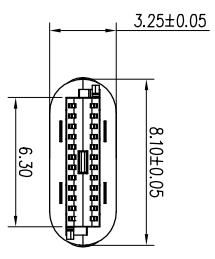

- Specification:
- Electrical Characteristics:
    - Contact Current Rating: 3 Amperes Max.
    - Rated Voltage: 30V Max.
    - Dielectric Withstanding Voltage: AC 100V r.m.s.
    - Insulation Resistance: 100 MΩ Minimum.
    - Contact Resistance: 40 mΩ Maximum.
  - Environmental:
    - Operating Temperature: -30°C~+85°C.
  - Mechanical Characteristics:
    - Insertion Force: 5~20Nf.
    - Withdrawal Force: 8~20Nf.
    - Durability Cycles: 10000 Cycles.
  - ⊗ Make is FAI test Dimension
  - ▼ Make is major test Dimension

5	EMC SPRING	Stainless Steel;SUS304,T=0.10mm;
4	CONTACT	Copper Alloy;AuNiSn;
3	LATCH	Stainless Steel;SUS304,T=0.35mm;
2	HOUSING	LCP Thermoplastic;UL94V-0;
1	SHELL	Stainless Steel;SUS304,T=0.15mm;
NO.	NAME	DESCRIPTION

A12	A11	A10	A9	A8	A7	A6	A5	A4	A3	A2	A1
GND	RX2+	RX2-	VBUS	SBUT	D-	D+	CC	VBUS	TX1-	TX1+	GND
GND	TX2+	TX2-	VBUS	Vcomm	□	□	SBU2	VBUS	RX1-	RX1+	GND
B1	B2	B3	B4	B5	B6	B7	B8	B9	B10	B11	B12

## 产品图

公差一览表 TOLERANCE UNLESS OTHERWISE SPECIFIED		单位 UNITS	MM
X	±0.30	X'	±5'
X	±0.25	X''	±2'
XX	±0.30	XX'	±1'
XXX	±0.15	XXX'	±0.5'

制图 DRAWING	王冠	产品料号 PRODUCT PART NO.	23005-1ICAM008-A
审核 CHECK	雷永健	产品名称 PRODUCT NO.	TYPE C 24P公头 正插聊合不带板
核准 APPROVE	雷永健	角法 VIEW	⊕ ⊖
日期 DATE	2009/10/20	版本 VER	A0