

ROHS 客户图

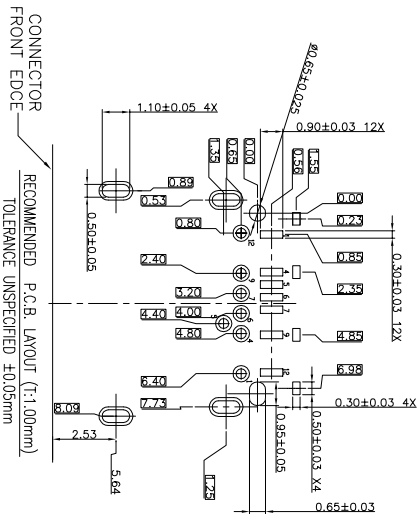

PIN	SIGNAL NAME	PIN	SIGNAL NAME
A1	GND	B1:2	GND
A4	VBUS	B9	VBUS
A5	CCI	B7	DN2
A6	DP1	B6	DP2
A7	DN1	B5	CC2
A9	VBUS	B4	VBUS
A12	GND	B1	GND

- NOTES:
SPECIFICATION:
1. CURRENT RATING: 1.5A MAX
 2. VOLTAGE: 100 VAC
 3. TEMPERATURE RANGE: -30 °C ~ 85 °C
 4. CONTACT RESISTANCE: 40 MILLIONHM MAX
 5. INSULATION RESISTANCE: 100 MEGOHMS MIN.
 6. INSERTION FORCE : 5N~20N
 7. UNMATING FORCE: 8N~20N
 8. DURABILITY: 10,000 CYCLES

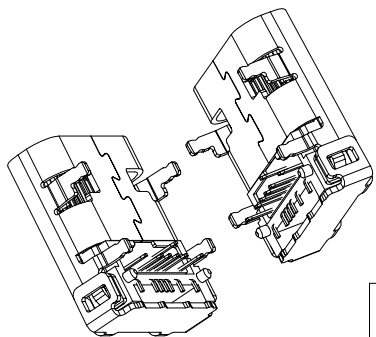
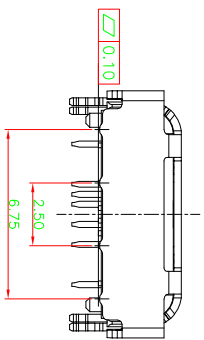
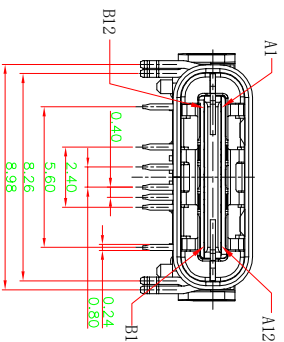
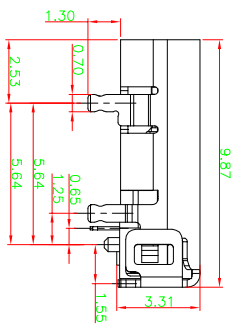
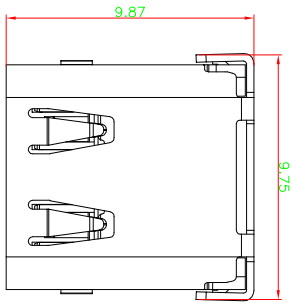
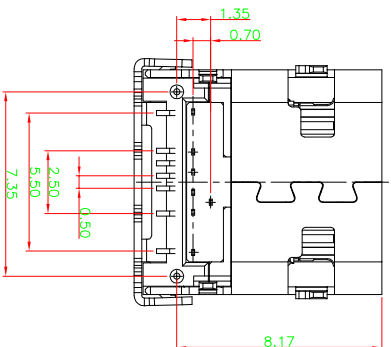

NO.	DESCRIPTION	MATERIAL	REMARKS	QTY
6	SHELL	STAINLESS STEEL	NI Plated	1PCS
5	SHIELDING PLATE	STAINLESS STEEL	---	1PCS
4	WD	HIGH TEMPERATURE PLASTIC	BLACK	1PCS
3	CONTACT	COPPER ALLOY	Au/NI Plated	1SET
2	CONTACT	COPPER ALLOY	Au/NI Plated	1SET
1	HOUSING	HIGH TEMPERATURE PLASTIC	BLACK	1PCS

产品图

公差一览表	单位	MM	制图	王冠	产品料号
TOLERANCE UNLESS OTHERWISE	UNITS		DRAWING		PRODUCT PART NO.
X	±0.30	X'	±5'	雷永健	24001-UCAP018-X
X	±0.25	X'	±2'	雷永健	产品名称
XX	±0.30	XX'	±1'	雷永健	TYPE C母座板上前插后贴14P
XXX	±0.15	XXX'	±0.5'	雷永健	角法
			DATE		版本
			2009/10/20		A0