

RoHS

客户图

目錄 MAPX	变更内容 MODIFICATION	日期 DATE
A0	NEW	09-10-20

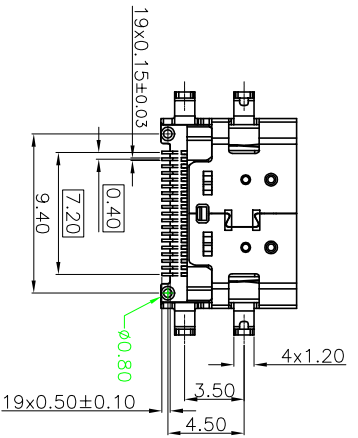
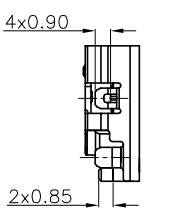
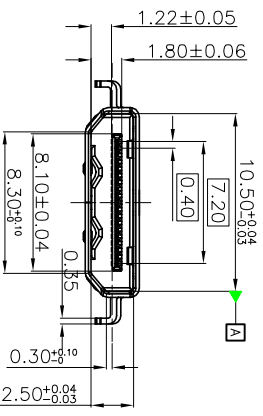
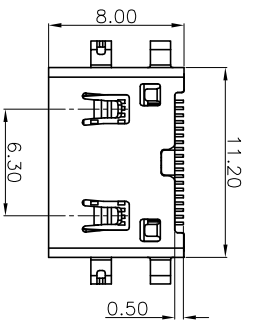

No.	PART NAME	QTY	MATERIAL	REMARK
3	SHELL	1	STEEL SK7	AU PLATED
2	CONTACT	19	COPPER ALLOY	AU/TIN PLATED
1	HOUSING	1	THERMOPLASTIC(LCP)	(UL 94V-0) BLACK

4. MATERIAL LIST:
- NOTES:
- ELECTRONIC:
    - CONTACT RESISTANCE: 20mohm MAX
    - INSULATION RESISTANCE: 1000 Mohm MIN
    - WITHSTAND VOLTAGE: AC 500V, 1min.
  - MECHANICAL:
    - DURABILITY: 10000 CYCLE.
    - ENVIRONMENT CHARACTERISTICS: OPERTING TEMPERATURE: -55°C TO +105°C

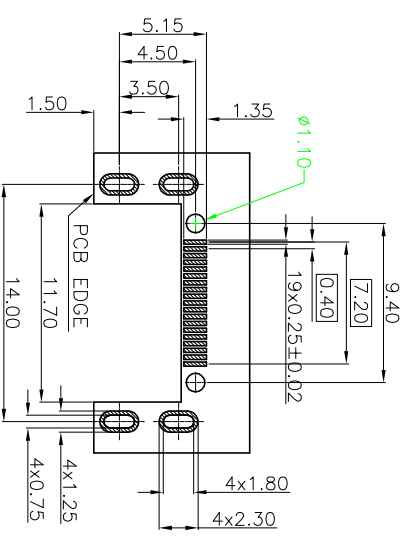

产品图

深圳市鑫风雷电子有限公司

公差一览表		单位		制图		产品料号	
TOLERANCE UNLESS OTHERWISE		UNITS		DRAWING		PRODUCT PART NO.	
X	±0.30	X	±5°	王冠	00207-HDC/F003-A		
X	±0.25	X	±2°	雷永健			
XX	±0.30	XX	±1°	审核			
XXX	±0.15	XXX	±0.5°	核准	雷永健		
		日期	2009/10/20	产品名称	HDMI C TYPE母座SMT 沉板 H1.50	版本	A0
		比例	1:1	画法			
		SCALE		VIEW			
		DATE		APPD			

# RoHS 客户图

目錄 MAPX	变更内容 MODIFICATION	日期 DATE
A0	NEW	09-10-20

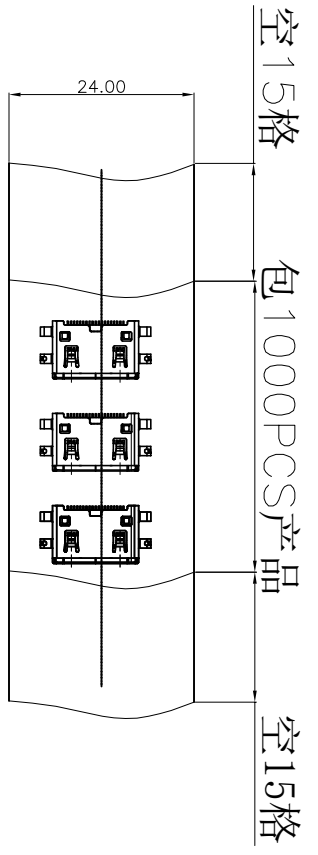
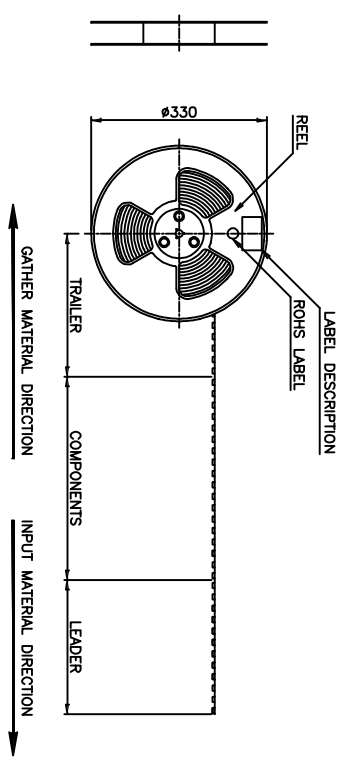

成品打板出料方向

- Notes:
1. THE START AND END OF EACH REEL, BASED ON THE ACTUAL QUANTITY, RESERVED 5--15PCS SPACE;
  2. COVER TAPE AND CARRY TAPE PEEL, 10g~130g, PEEL DEG.:165°~175°;
  3. QTY: 1000PCS/REEL, 10REEL/CARTON, TOTAL 10000PCS/CARTON;

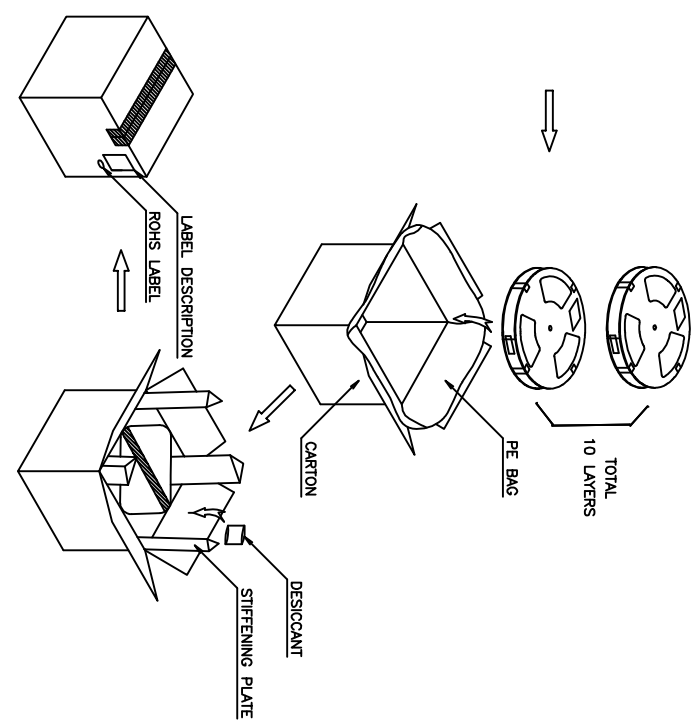

## 产品图

公差一览表 TOLERANCE UNLESS OTHERWISE		单位 UNITS	MM	制图 DRAWING	王冠	产品料号 PRODUCT PART NO.	00207-HDC/F003-A
X	±0.30	X'	±5'	审核 CHKD	雷永健	产品名称 PRODUCT NO.	HDMI C TYPE母座SMT 沉板 H1.50
XX	±0.25	XX'	±2'	核准 APPD	雷永健	角法 VIEW	⊕ □
.XXX	±0.15	.XXX'	±0.5'	日期 DATE	2009/10/20	版本 VER	A0