

1 2 3 4 5 6 7 8 9 10

# RoHS

## 客户图

|            |                      |            |
|------------|----------------------|------------|
| 目錄<br>MAPX | 變更內容<br>MODIFICATION | 日期<br>DATE |
| A0         | NEW                  | 09-10-20   |

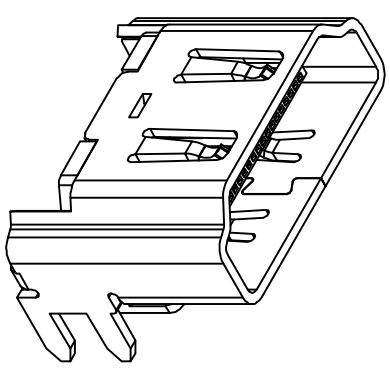
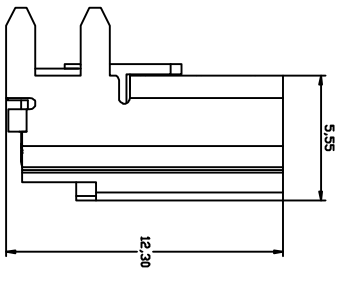
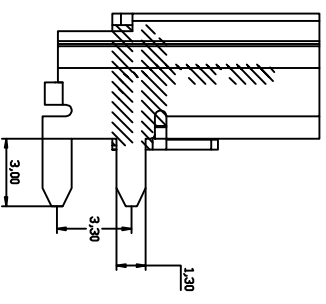
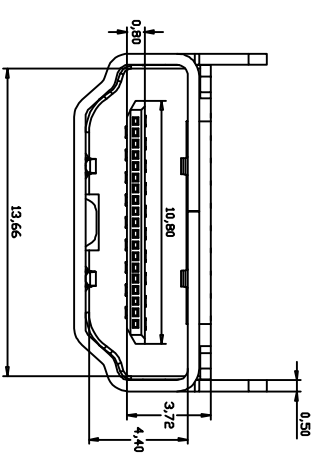
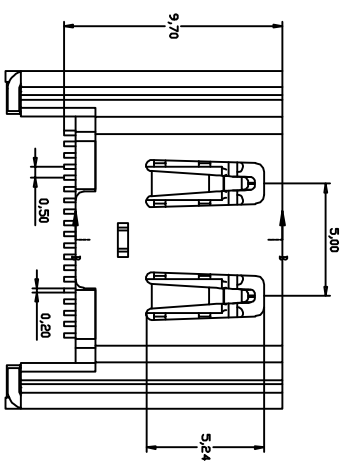
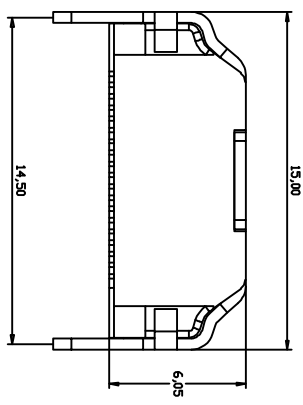

- NOTES:
- MATERIAL:
    - HOUSING: HIGH TEMPERATURE THERMOPLASTIC
    - CONTACT: COPPER ALLOY,T=0.20mm
    - SHELL: COPPER ALLOY,T=0.50mm,MATTE SURFACE
  - PLATING:
    - CONTACT:
      - GOLD PLATING ON CONTACT AREA AND MATTE TIN 100 $\mu$  ON SOLDER AREA
      - NICKEL UNDERPLATING
      - SHELL:
        - MIN. NICKEL PLATING OVER ALL

### 产品图

PRODUCT CHART DWG

### 公差一览表

| TOLERANCE UNLESS OTHERWISE | 公差         | UNIT | 制图         | 审核  | 产品料号            | 产品名称                 | 角法 | 版本 |
|----------------------------|------------|------|------------|-----|-----------------|----------------------|----|----|
| X                          | $\pm 0.30$ | X'   | $\pm 5'$   | 王冠  | 00711-HDMI A1-X | HDMI A TYPE 板上反向贴片母座 |    | A0 |
| X                          | $\pm 0.25$ | X'   | $\pm 2'$   | 雷永健 |                 |                      |    |    |
| XX                         | $\pm 0.30$ | XX'  | $\pm 1'$   | 雷永健 |                 |                      |    |    |
| .XXX                       | $\pm 0.15$ | XXX' | $\pm 0.5'$ | 雷永健 |                 |                      |    |    |

深圳市鑫风雷电子有限公司  
Shenzhen xinfenglei Electronic Co., Ltd