

RoHS 客户图

目錄 MAPX	变更内容 MODIFICATION	日期 DATE
A0	NEW	09-10-20

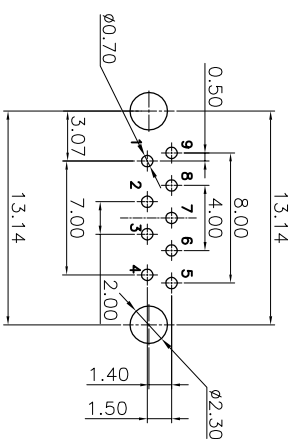
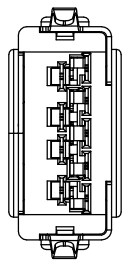
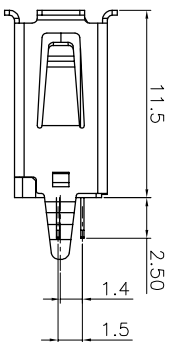
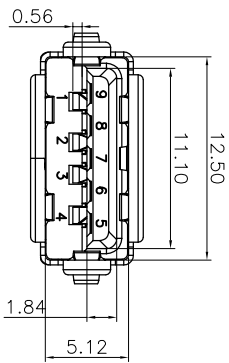
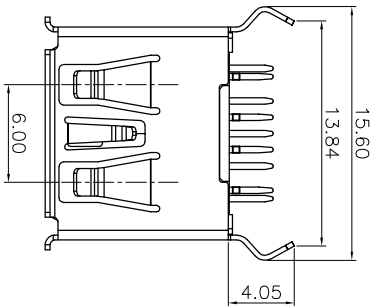

- NOTES:
- 1.MATERIAL:
 1.1 HOUSING: HIGH TEMPERATURE THERAL PLASTIC.
 1.2 SPRING CONTACT: COPPER ALLOY.
 1.3 FLAT CONTACT:COPPER ALLOY
 1.4 SHELL :COPPER ALLOY.
 1.5 COVER:HIGH TEMPERATURE THERAL PLASTIC.
- 2.FINISH:
 2.1 CONTACT: (SEE P/N,)[50μ"] MIN. NICKEL UNDERPLATING OVER ALL.
 2.2 SHELL: [50μ"] MIN.SOLDERABILITY NICKEL UNDERPLATING OVER ALL.

PIN NO.	PIN 1	PIN 2	PIN 3	PIN 4
SIGNAL NAME	V BUS	D-	D+	GND
REMARK	USB 2.0 CONTACT PINS			

PIN NO.	PIN 5	PIN 6	PIN 7	PIN 8	PIN 9
SIGNAL NAME	STDA_SSRX-	STDA_SSRX+	GND_DRAIN	STDA_SSTX-	STDA_SSTX+
REMARK	USB 3.0 CONTACT PINS				

产品图

深圳市鑫风雷电子有限公司

公差一览表 TOLERANCE UNLESS OTHERWISE		单位 UNITS	MM	制图 DRAWING	王冠	产品料号 PRODUCT PART NO.	00505-13AP001-X
X	±0.30	X'	±5'	比例 SCALE	1:1	审核 CHKD	雷永健
XX	±0.30	XX'	±2'	日期 DATE	2009/10/20	核准 APPD	雷永健
XXX	±0.15	XXX'	±0.5'	角法 VIEW	⊕	版本 VER	A0