

# ROHS 客户图

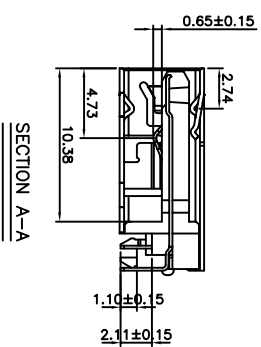

TOLERANCE: ±0.05, THICKNESS: 1.2mm  
RECOMMENDED PCB LAYOUT  
(TOP VIEW)  
KEEP OUT AREA

- NOTE:
- MATERIAL:
    - INSULATOR: 塑胶9T PLASTIC UL 94 V-0; BLUE
    - CONTACT: C5191-H (T=0.20mm)
    - SHELL: SUS201 (T=0.30mm)
  - ELECTRICAL CHARACTERISTICS:
    - CONTACT RESISTANCE: 30mΩ Max
    - CONTACT CURRENT RATING: 1.5A
    - DIELECTRIC WITHSTANDING VOLTAGE: 500 V R.M.S.
    - INSULATION RESISTANCE 1000 MEGOHMS Min
  - MECHANICAL CHARACTERISTICS:
    - MATING FORCE: 35 N Max
    - UNMATED FORCE: 10 N Min INITIAL; 8 N Min AFTER TEST
    - DURABILITY: 5,000 CYCLES
  - PLATING
    - TERMINAL CONTACT: (SEE TAB) GOLD PLATING ALL OVER 50μ" MIN NICKEL AND 100μ" MIN MATTE TIN ALL OVER 50μ" MIN NICKEL ON SOLDER AREA
    - SHELL: 50μ" MIN NICKEL ALL OVER
  - PART NUMBER:

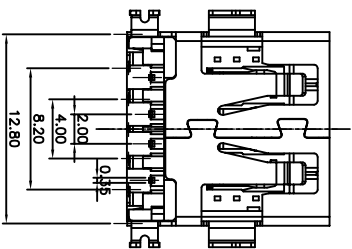
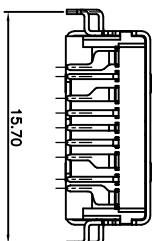
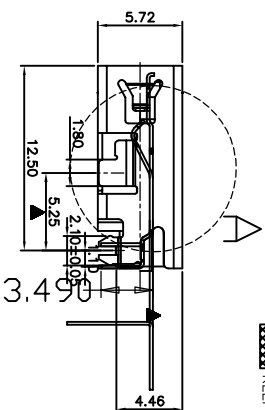
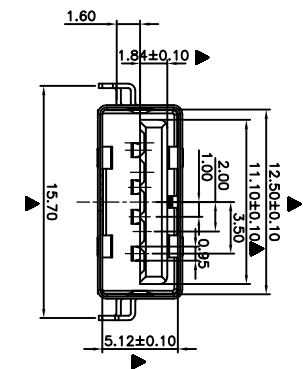
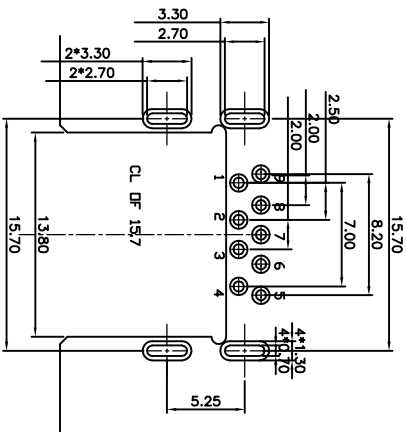
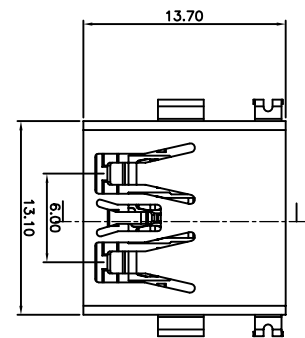
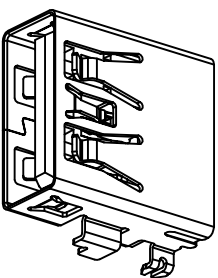

Pin #	1	2	3	4	5	6	7	8	9	Shield
SIGNAL NAME	VBUS	D-	D+	GND	SIDA_SSRX	SIDA_SSRX	SIDU_DRAIN	SIDA_SST	SIDA_SST	Shield

## 产品图

深圳市鑫风雷电子有限公司  
Shenzhen xinfenglei Electronic Co., Ltd

公差一览表		单位		比例		日期		核准		角法		版本	
TOLERANCE UNLESS OTHERWISE	UNITS	SCALE	DATE	APPD	VIEW	VER							
X	±0.30	X'	±5'										
XX	±0.25	X'	±2'										
XX	±0.30	XX'	±1'										
.XXX	±0.15	XXX'	±0.5'										