

RoHS 客户图

| FIN. ASSIGNMENT | |
|-----------------|--------|
| A1 | A3 |
| A2 | A4 |
| A3 | A5 |
| A4 | A6 |
| A5 | A7 |
| A6 | A8 |
| A7 | A9 |
| A8 | A10 |
| A9 | A11 |
| A10 | A12 |
| FINISH | ROZ1 |
| FINISH | ROZ2 |
| FINISH | ROZ3 |
| FINISH | ROZ4 |
| FINISH | ROZ5 |
| FINISH | ROZ6 |
| FINISH | ROZ7 |
| FINISH | ROZ8 |
| FINISH | ROZ9 |
| FINISH | ROZ10 |
| FINISH | ROZ11 |
| FINISH | ROZ12 |
| FINISH | ROZ13 |
| FINISH | ROZ14 |
| FINISH | ROZ15 |
| FINISH | ROZ16 |
| FINISH | ROZ17 |
| FINISH | ROZ18 |
| FINISH | ROZ19 |
| FINISH | ROZ20 |
| FINISH | ROZ21 |
| FINISH | ROZ22 |
| FINISH | ROZ23 |
| FINISH | ROZ24 |
| FINISH | ROZ25 |
| FINISH | ROZ26 |
| FINISH | ROZ27 |
| FINISH | ROZ28 |
| FINISH | ROZ29 |
| FINISH | ROZ30 |
| FINISH | ROZ31 |
| FINISH | ROZ32 |
| FINISH | ROZ33 |
| FINISH | ROZ34 |
| FINISH | ROZ35 |
| FINISH | ROZ36 |
| FINISH | ROZ37 |
| FINISH | ROZ38 |
| FINISH | ROZ39 |
| FINISH | ROZ40 |
| FINISH | ROZ41 |
| FINISH | ROZ42 |
| FINISH | ROZ43 |
| FINISH | ROZ44 |
| FINISH | ROZ45 |
| FINISH | ROZ46 |
| FINISH | ROZ47 |
| FINISH | ROZ48 |
| FINISH | ROZ49 |
| FINISH | ROZ50 |
| FINISH | ROZ51 |
| FINISH | ROZ52 |
| FINISH | ROZ53 |
| FINISH | ROZ54 |
| FINISH | ROZ55 |
| FINISH | ROZ56 |
| FINISH | ROZ57 |
| FINISH | ROZ58 |
| FINISH | ROZ59 |
| FINISH | ROZ60 |
| FINISH | ROZ61 |
| FINISH | ROZ62 |
| FINISH | ROZ63 |
| FINISH | ROZ64 |
| FINISH | ROZ65 |
| FINISH | ROZ66 |
| FINISH | ROZ67 |
| FINISH | ROZ68 |
| FINISH | ROZ69 |
| FINISH | ROZ70 |
| FINISH | ROZ71 |
| FINISH | ROZ72 |
| FINISH | ROZ73 |
| FINISH | ROZ74 |
| FINISH | ROZ75 |
| FINISH | ROZ76 |
| FINISH | ROZ77 |
| FINISH | ROZ78 |
| FINISH | ROZ79 |
| FINISH | ROZ80 |
| FINISH | ROZ81 |
| FINISH | ROZ82 |
| FINISH | ROZ83 |
| FINISH | ROZ84 |
| FINISH | ROZ85 |
| FINISH | ROZ86 |
| FINISH | ROZ87 |
| FINISH | ROZ88 |
| FINISH | ROZ89 |
| FINISH | ROZ90 |
| FINISH | ROZ91 |
| FINISH | ROZ92 |
| FINISH | ROZ93 |
| FINISH | ROZ94 |
| FINISH | ROZ95 |
| FINISH | ROZ96 |
| FINISH | ROZ97 |
| FINISH | ROZ98 |
| FINISH | ROZ99 |
| FINISH | ROZ100 |

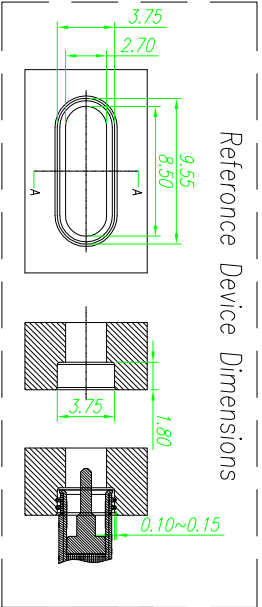
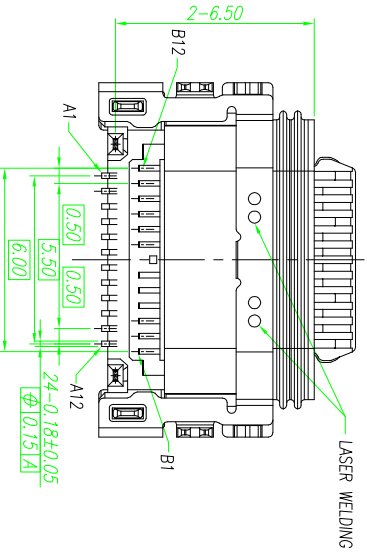
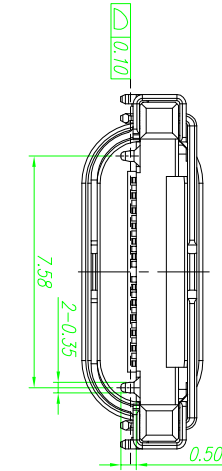
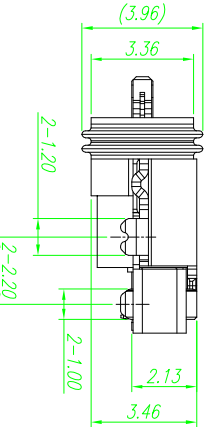
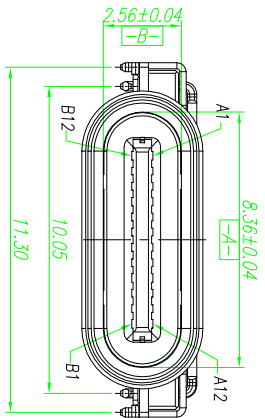
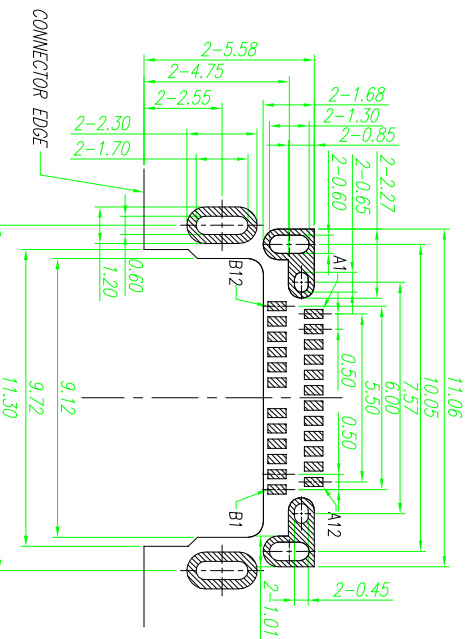
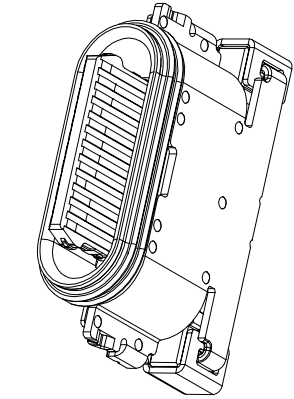
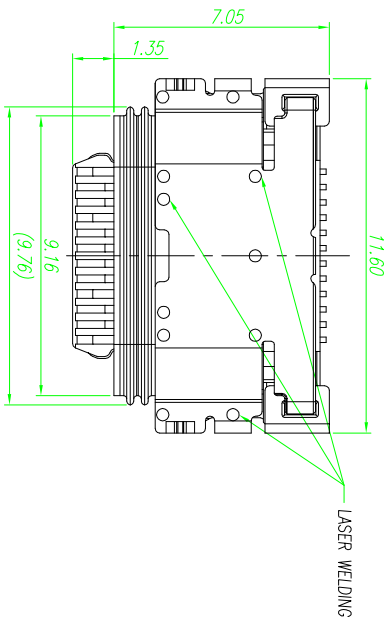

| NO. | DESCRIPTION | QTY. | MATERIAL | FINISHED |
|-----|-------------|-------|-----------------|----------------|
| 1 | MAIN SHELL | 1 PCS | STAINLESS STEEL | Ni Plated |
| 2 | IM HOUSING | 1 PCS | PLASTIC | None |
| 3 | CONTACT | 1 SET | COPPER ALLOY | Au & Ni Plated |
| 4 | UP+DW_SHELL | 1 PCS | STAINLESS STEEL | Ni Plated |

SPECIFICATION:

1. ELECTRICAL CHARACTERISTICS:

- 1.1 CURRENT RATING: 5 A
- 1.2 TEMPERATURE RANGE: -40 °C ~ 85 °C
- 1.3 CONTACT RESISTANCE: 30 MILLIONHM MAX.
- 1.4 DIELECTRIC WITHSTANDING VOLTAGE: 100 VAC r.m.s
- 1.5 INSULATION RESISTANCE: 100 MEGOHMS MIN.

2. MECHANICAL CHARACTERISTICS

- 2.1 INSERTION FORCE: 5~20N
- 2.2 EXTRACTION FORCE: Initial:8~20N, ATER TEST 6~20N
- 2.3 DURABILITY:10,000CYCLES

3. THE SHELL LENGTH IS LESS THAN THE MINIMUM SPECIFIED BY THE USB TYPE C STANDARDS. SUCH IS CANNOT INDEPENDENTLY BE GUARANTEED TO MEET ALL TYPE C MECHANICAL REQUIREMENTS.

产品图

PRODUCT CHART DWG

| 公差一览表 | | | |
|-----------|------------------|-----------|-------|
| TOLERANCE | UNLESS OTHERWISE | OTHERWISE | SCALE |
| X | ±0.30 | X' | ±5' |
| X | ±0.25 | X' | ±2' |
| XX | ±0.30 | XX' | ±1' |
| XXX | ±0.15 | XXX' | ±0.5' |

| 单位 | | 比例 | | 日期 | |
|-------|-------|-------|------------|------|------|
| UNITS | SCALE | SCALE | DATE | DATE | DATE |
| MM | 1:1 | 1:1 | 2009/10/20 | | |

深圳市鑫风雷电子有限公司

Shenzhen xinfenglei Electronic Co., Ltd

| 制图 | 审核 | 核准 | 产品料号 | 产品名称 | 角法 | 版本 |
|-------------|-------------|-------------|------------------|---|-------|-----|
| DRAWING | CHKD | APPD | PRODUCT PART NO. | PRODUCT NO. | ANGLE | VER |
| 王冠 | 雷永健 | 雷永健 | 19009-UCAR031-X | Type C 24pin母座(长度:2.13-1.8-4 5pin外翻:1.38 脚水 | | A0 |
| Leiyoungjun | Leiyoungjun | Leiyoungjun | | | | |

RoHS 客户图

| | | |
|------------------|-----------------------------|------------------------|
| 目錄 MAPX A0 | 設定內容 MODIFICATION NEW | 日期 DATE 09-10-20 |
|------------------|-----------------------------|------------------------|

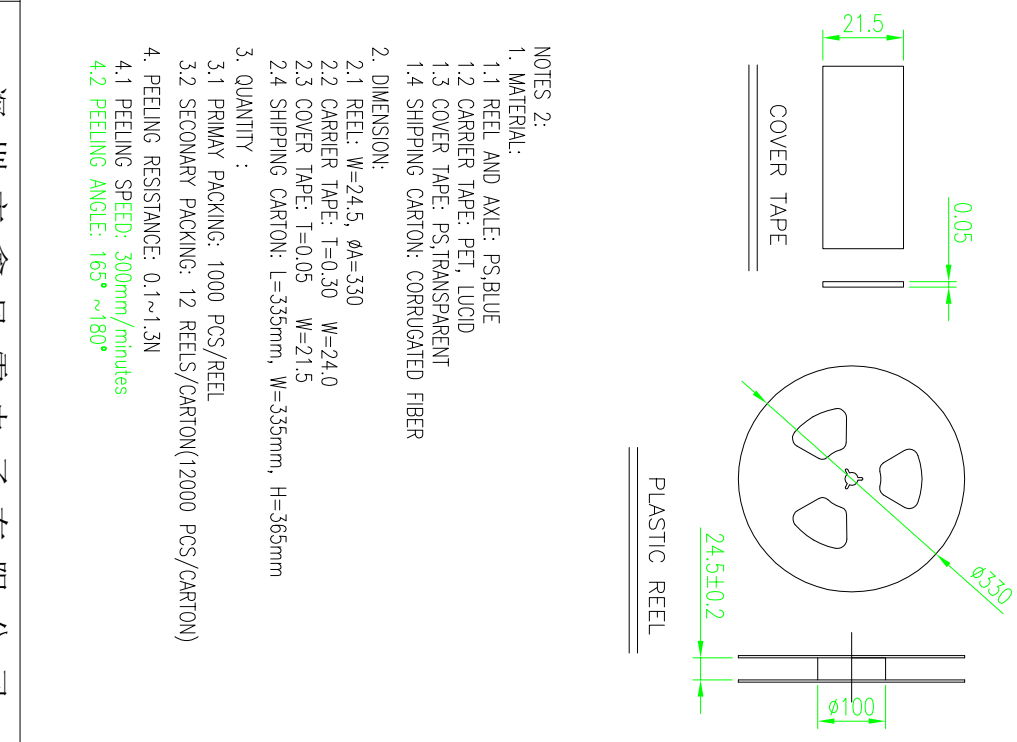
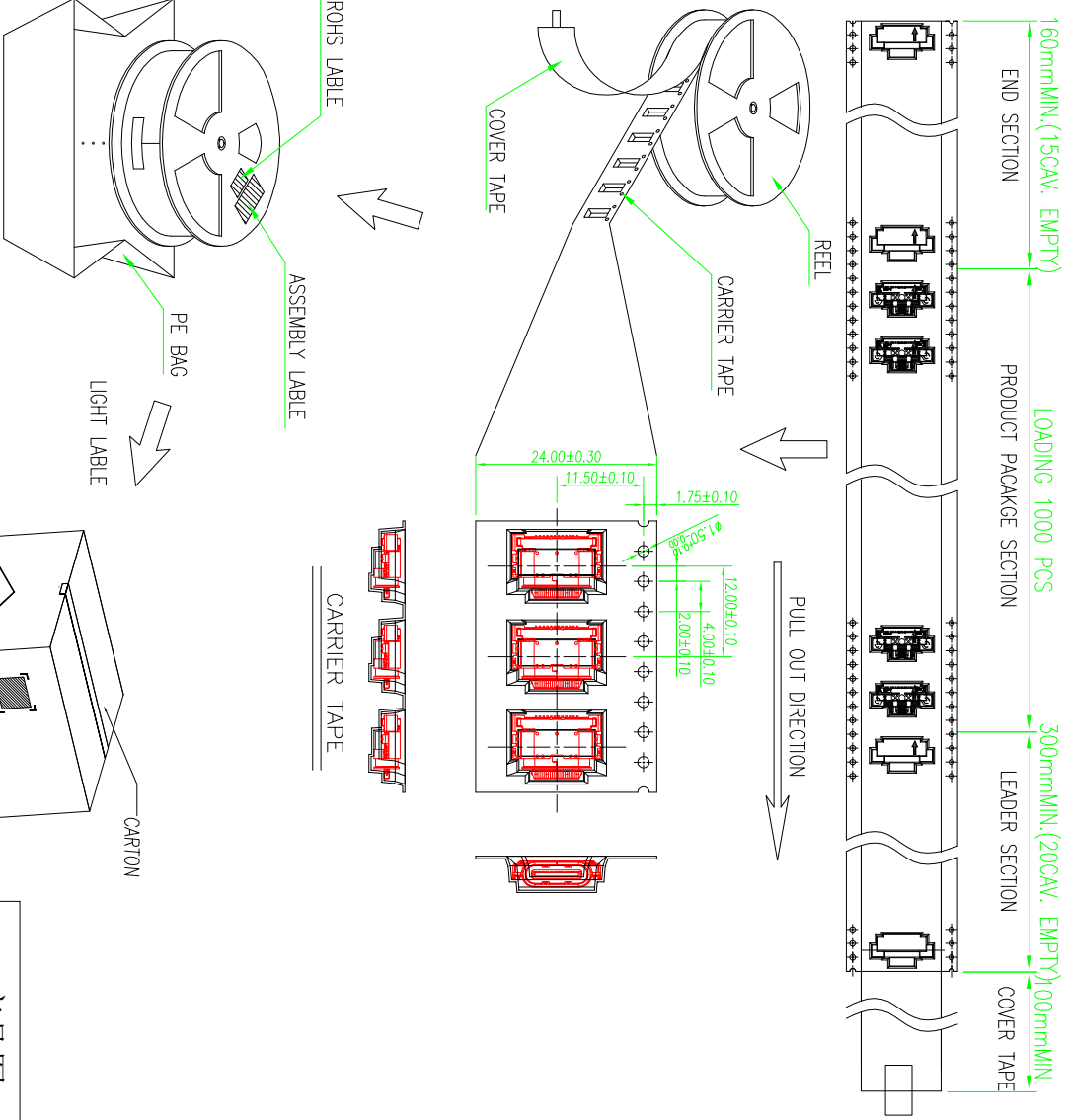

- NOTES: 2:
- MATERIAL:
 - 1.1 REEL AND AXLE: PS,BLUE
 - 1.2 CARRIER TAPE: PET, LUCID
 - 1.3 COVER TAPE: PS,TRANSPARENT
 - 1.4 SHIPPING CARTON: CORRUGATED FIBER
 - DIMENSION:
 - 2.1 REEL: W=24.5, φA=330
 - 2.2 CARRIER TAPE: T=0.30 W=24.0
 - 2.3 COVER TAPE: T=0.05 W=21.5
 - 2.4 SHIPPING CARTON: L=335mm, W=335mm, H=365mm
 - QUANTITY:
 - 3.1 PRIMARY PACKING: 1000 PCS/REEL
 - 3.2 SECONDARY PACKING: 12 REELS/CARTON(12000 PCS/CARTON)
 - PEELING RESISTANCE: 0.1~1.3N
 - 4.1 PEELING SPEED: 3000mm/minutes
 - 4.2 PEELING ANGLE: 165°~180°

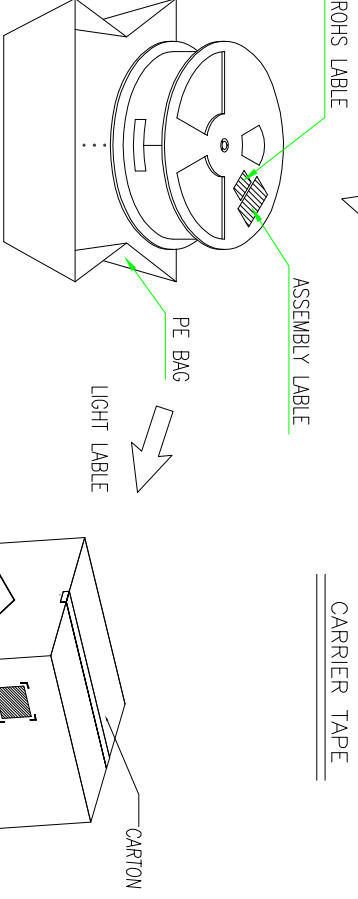

产品图

Product Chair DWG
Shenzhen xinfenglei Electronic Co., Ltd

| | | | | | | | | | | | |
|-------------------------------------|-------|-------------|-------------|------------|----------------|--------------------|--------------------|--------------------------|---|------------|-----------|
| 公差一览表 TOLERANCE UNLESS OTHERWISE | | 单位 UNITS | 比例 SCALE | 日期 DATE | 制图 DRAWING | 审核 CHECK | 核准 APPRO | 产品料号 PRODUCT PART NO. | 产品名称 PRODUCT NO. | 角法 VIEW | 版本 VER |
| X | ±0.30 | X | ±5° | 2009/10/20 | 王冠 Wangguan | 雷永健 Leiyongjian | 雷永健 Leiyongjian | 19009-UCAR031-X | Type C 2# 母座间距=2.13 L=8.4 5# 在外侧; 3# 即水 | ⊕ | A0 |
| XX | ±0.25 | X' | ±2° | | | | | | | | |
| XX | ±0.30 | XX' | ±1° | | | | | | | | |
| XXX | ±0.15 | XXX' | ±0.5° | | | | | | | | |