

ROHS 客户图

目錄 MAPX A0	變更內容 MODIFICATION NEW	日期 DATE 19-10-20
------------------	-----------------------------	------------------------

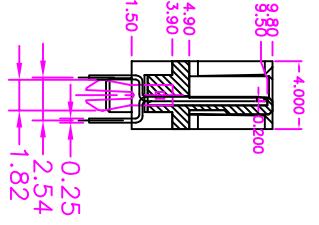
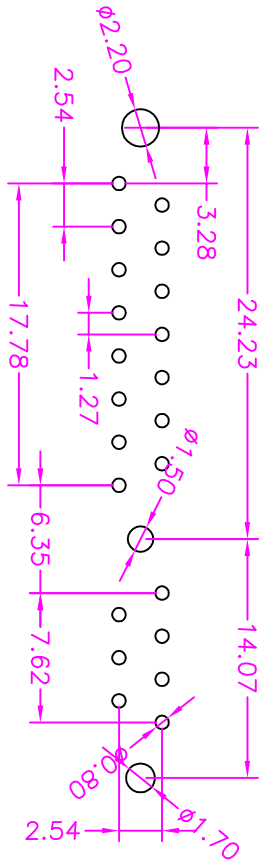
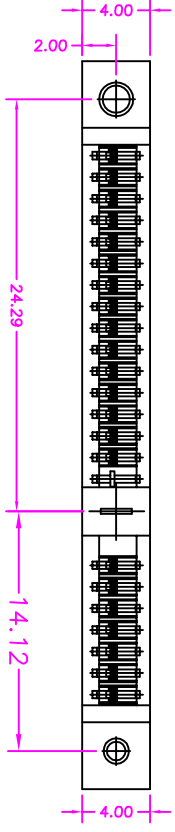
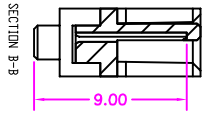
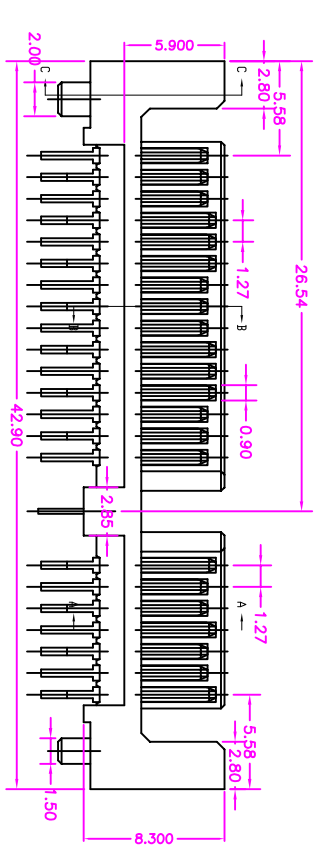
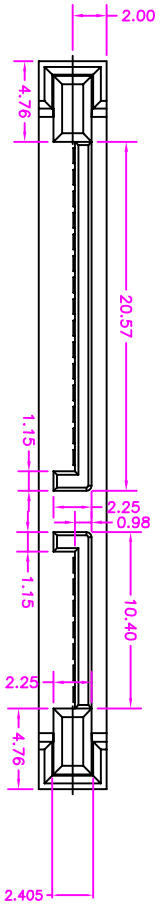

PART NO.: 8010M-0000001-X

SERISE: SATA Plug

serial number

Variable

SPECIFICATION:
 1.MATERIAL HOUSING: LCP E130I 30% G/F UL 94V-0
 2.COLOR: BLACK
 3.CONTACT: BRASS C2680R EHT=0.25mm
 4.PLATING CONTACT: 10u" 3u" 5u" 15u" 30u" Au/TIN PLATING ON CONTACT AREA
 5.100u" MIN. TIN PLATING ON SOLDER TAILS
 6.50u" MIN. NICKEL UNDERPLATING OVER ALL

产品图

PRODUCT CHART DWG

深圳市鑫风雷电子有限公司
 Shenzhen xinfenglei Electronics Co., Ltd

公差一览表 TOLERANCE UNLESS OTHERWISE SPECIFIED		单位 UNITS	MM
X	±0.30	X	±5°
XX	±0.25	X	±2°
XXX	±0.15	XXX	±1°
XXX	±0.15	XXX	±0.5°

制图 DRAWING	王冠 Wangguan	产品料号 PRODUCT PART NO.	8010M-0000001-X
审核 CHECK	雷永健 Lei Yongjian	产品名称 PRODUCT NO.	SATA 7+15P 公头, 180度 插板 带鱼叉 H=8.3
日期 DATE	2009/10/20	联系方式 CONTACT INFO	mailto:sale@xfli.com www.xfli.com